



INSTALLATION GUIDE

2025-UP/RAM RHO

BOMBER REAR BUMPER

R630141280103



TOOLS REQUIRED

(Allen) 5/32

(Wrench) 10mm, 15mm, 16mm, 7/16, 3/4, 13/16

(Socket) 10mm, 15mm, 16mm, 7/16, 3/4, 13/16

Ratchet

Flat Head/Fastener Remover

Cutting tools (Grinder)



TIME REQUIRED

- 2 hours for OEM Removal/Bumper Install

-1 Additional Hour to Wire Lights

****Labor Rates are based on a vehicle with no pre-existing damage. Wiring labor is based on a standard wiring procedure with light switches installed in an easily accessible location. Custom light triggering or switch mounting location will result in a greater labor charge.****



SKILL LEVEL



Easy

****This installation requires 2 people for best results****



WARNINGS/CAUTIONS BEFORE STARTING INSTALLATION



-BEFORE YOU INSTALL THIS KIT-

Read and understand all instructions, warnings, cautions, & notes contained in this installation instruction guide. Consult your vehicle owner's manual for proper disconnection of electrical and lifting of vehicle if required for installation of this product.

This install may require some technical skills and knowledge of basic mechanical work. If you do not feel that you are capable of performing this install please take this product to a trained professional.

After reading this guide please contact us with any questions or concerns before installing product.

Customer Service (480) 671-0820

Addictive desert designs is not responsible for any bodily injury or harm to you or your vehicle as a result of an improper install.

Proper installation of this kit required knowledge of the factory recommended procedures for removal and installation of original equipment components.

We recommend that the factory shop manual and any special tools needed to service your vehicle be on hand during the installation. Installation of this kit without proper knowledge of the factory recommended procedures may affect the performance of these

components and the safety of the vehicle.

Inspect all contents of this package to make sure product is not damaged and all installation hardware has been included. If parts are missing from kit, please be prepared to provide the following information:

1. Name of purchase location
2. Bar Code on side of box
3. Date above bar code
4. Date inside box cover

***ALWAYS WEAR EYE PROTECTION
WHEN OPERATING POWER TOOLS***



INSTALLATION GUIDE

HARDWARE

A.



1/4-20 X 3/4" BUTTON HEAD BOLT

QTY: 14

A1.



1/4" FLAT WASHER

QTY: 14

A2.



1/4-20" NYLON LOCK NUT

QTY: 14

B.

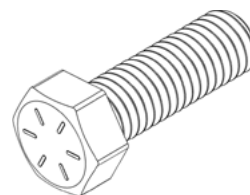

1/2-13 X 1 1/4" HEX HEAD BOLT GRADE 8

QTY: 4

B1.



1/2" FLAT WASHER YELLOW ZINC

QTY: 8

B2.

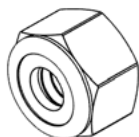

1/2-13" NYLON LOCK NUT GRADE 8

QTY: 4

C.



1/4" PLASTIC SNAP IN NUT

QTY: 2

C1.



#12 X 3/4 FLANGED SCREW

QTY: 2

D.



MOPAR BEZEL RETAINER

QTY: 4

D1.



MOPAR BEZEL

QTY: 4

SENSOR GROMMETS SUPPLIED FOR NON SENSOR TRIMS



3/4" RUBBER SENSOR GROMMET
QTY: 5



3/4" PLASTIC SENSOR GROMMET PLUG
QTY: 4

Reference this page throughout the install



INSTALLATION GUIDE

PARTS

E.

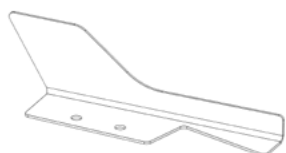

ASF0268, ASF0268-M

QTY: 1

F.

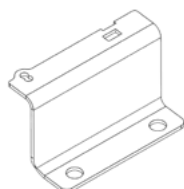

APH0053B, APH0053-MB

QTY: 1

G.

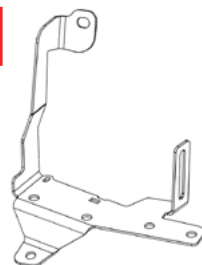

ASF0266B, ASF0266-MB

QTY: 1

H.

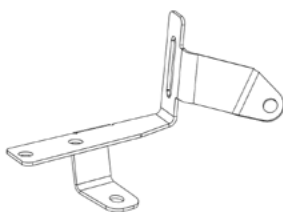

ABR0088, ABR0088-M

QTY: 1

I.

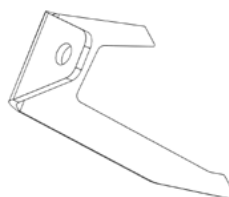

SSF1091, SSF1091-M

QTY: 1

J.

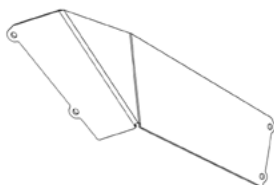

PPL0006

QTY: 1

J1.

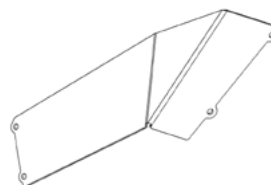

PPL0005

QTY: 1



INSTALLATION GUIDE

BOMBER REAR BUMPER

2025-UP/RAM RHO

REMOVAL

□ STEP 1

Disconnect the main wire harness located on the driver side frame rail.





INSTALLATION GUIDE

BOMBER REAR BUMPER

2025-UP/RAM RHO

REMOVAL

□ STEP 2

Remove the two bolts that are highlighted below using a (15mm socket).





INSTALLATION GUIDE

BOMBER REAR BUMPER

2025-UP/RAM RHO

REMOVAL

□ STEP 3

Using a (16mm Socket) to remove the four bumper mounting bolts. Then, remove the OEM bumper from the vehicle.

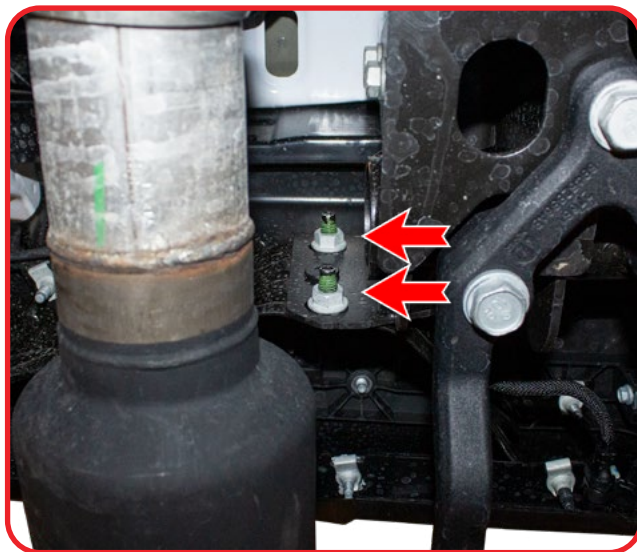
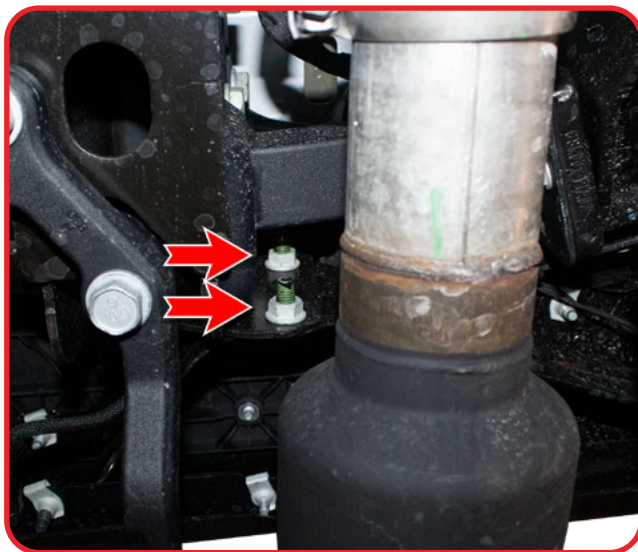



INSTALLATION GUIDE

BOMBER REAR BUMPER

2025-UP/RAM RHO

REMOVAL

□ STEP 4

(OPTIONAL) Using a (13/16 socket), Remove the tow hooks located underneath the hitch next to the spare tire and exhaust.

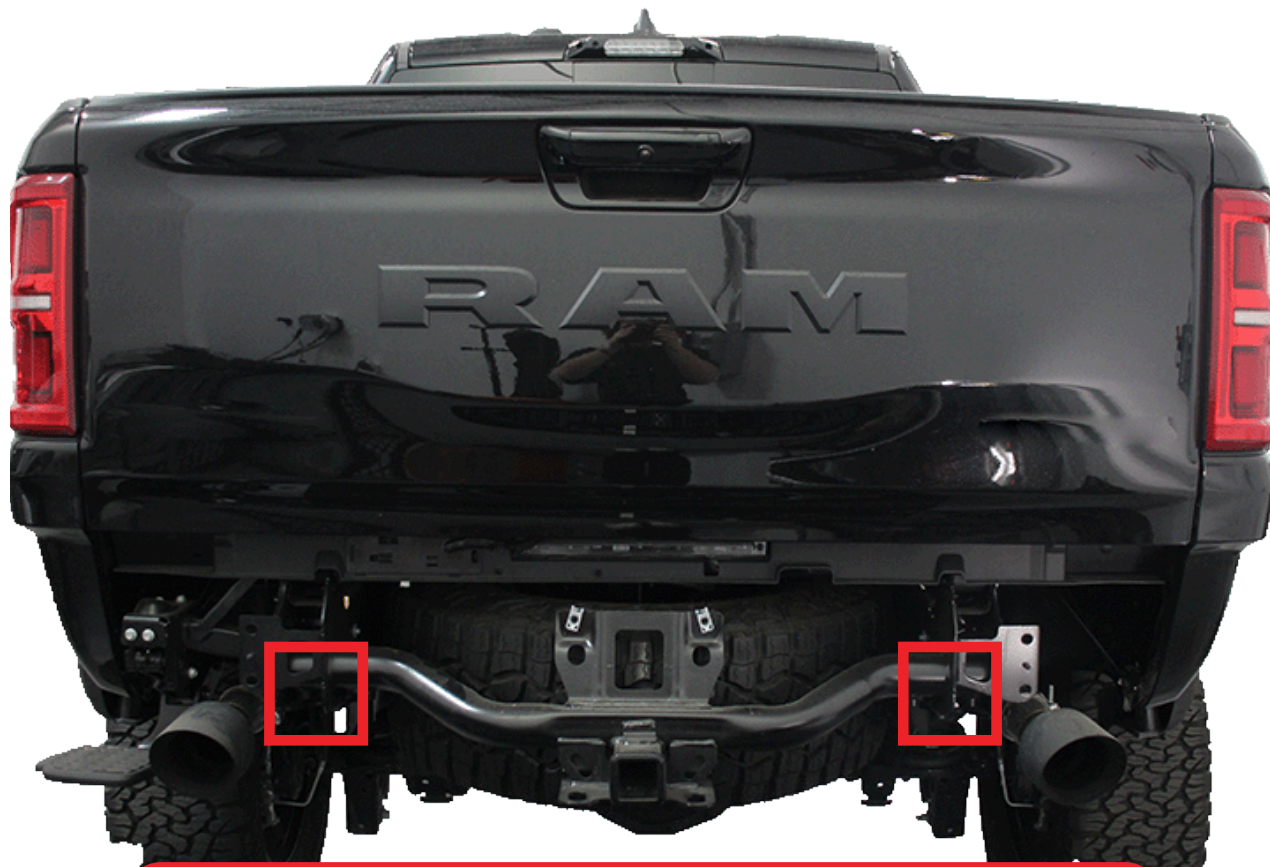



INSTALLATION GUIDE

BOMBER REAR BUMPER

2025-UP/RAM RHO

REMOVAL

□ STEP 5

Remove the plastic clips located on both driver and passenger side in the highlighted areas using a (fastener removal tool/flathead screwdriver).

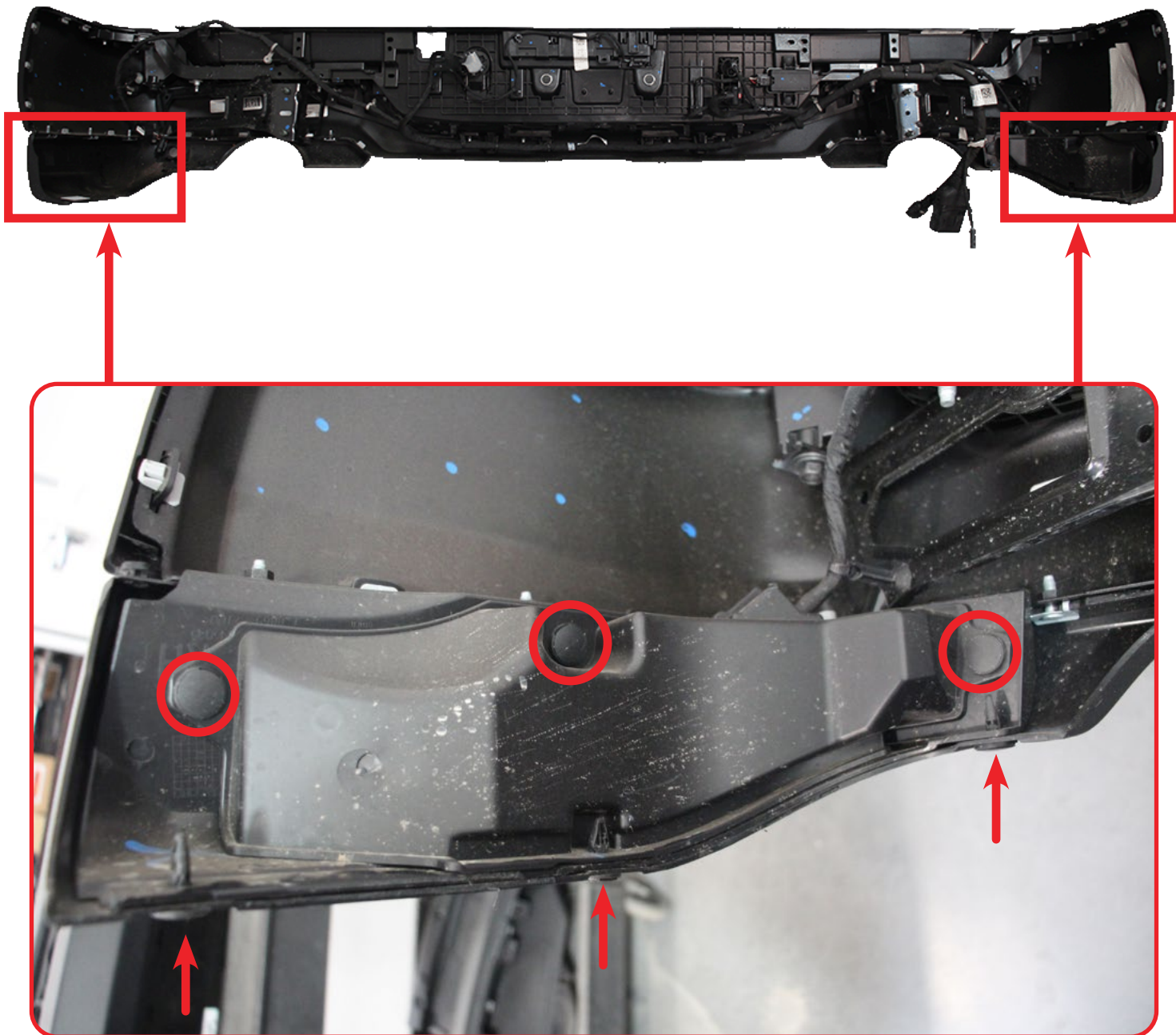



INSTALLATION GUIDE

BOMBER REAR BUMPER

2025-UP/RAM RHO

REMOVAL

□ STEP 6

Unplug the BSM and mid range sensor as shown below.

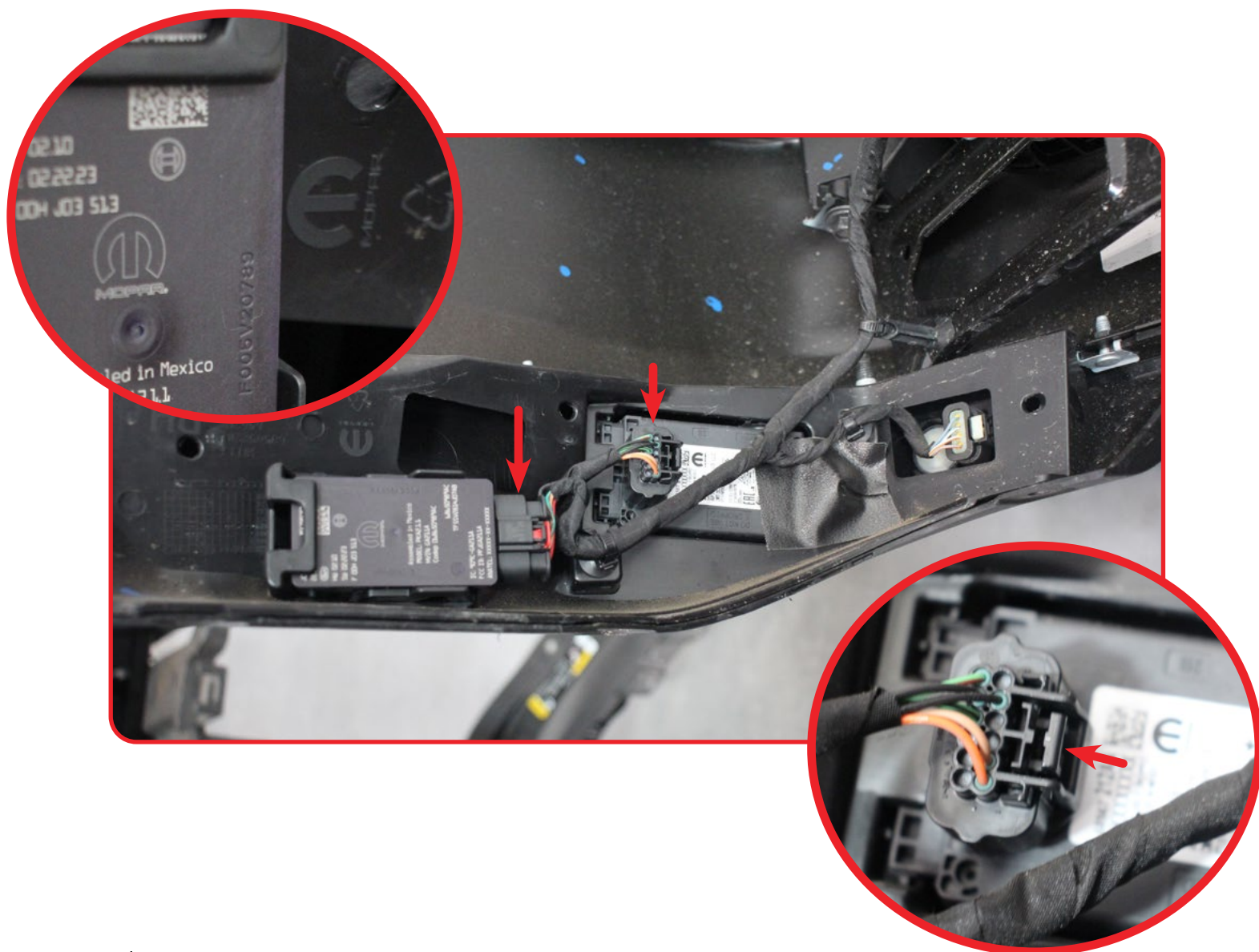
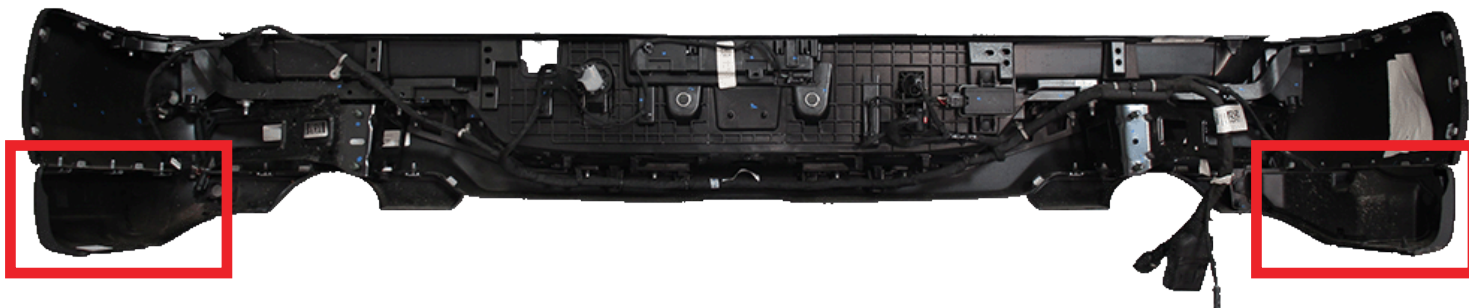

BOMBER REAR BUMPER

2025-UP/RAM RHO

REMOVAL

□ STEP 7

Remove the plastic trees shown below using a (fastener removal tool).

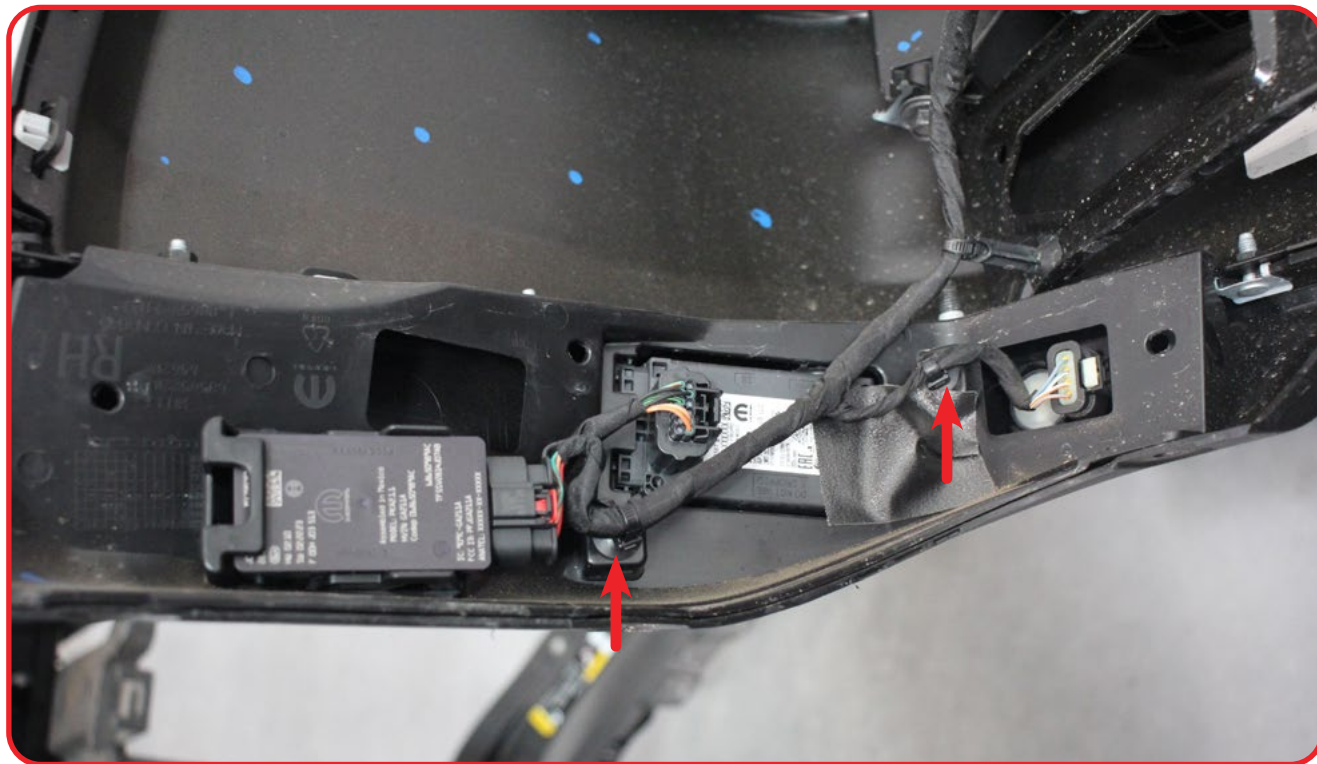

BOMBER REAR BUMPER 2025-UP/RAM RHO

REMOVAL

□ STEP 8

Using a (10mm socket) remove the hardware located above the BSM and mid range sensor.

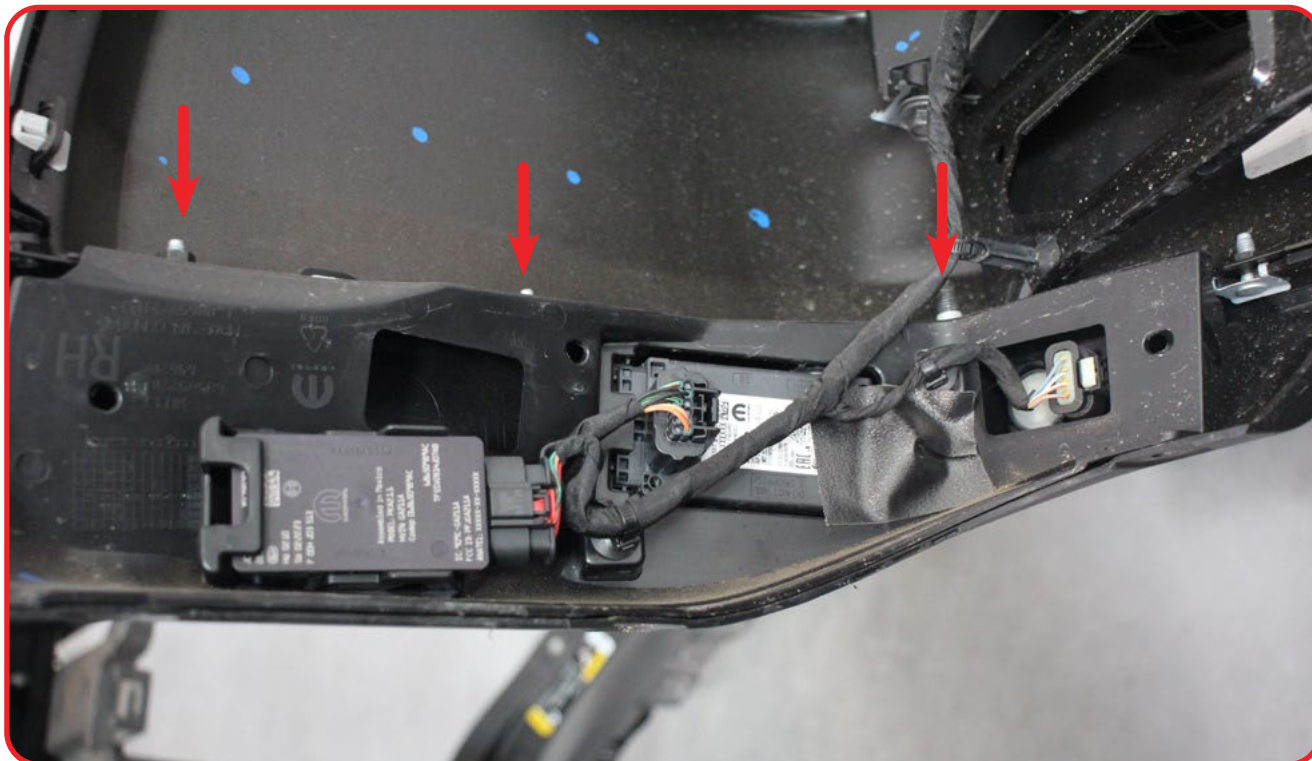

BOMBER REAR BUMPER

2025-UP/RAM RHO

REMOVAL

□ STEP 9

With the plastic retainer removed, remove the BSM and mid range sensor by prying the tabs as shown below with your finger.

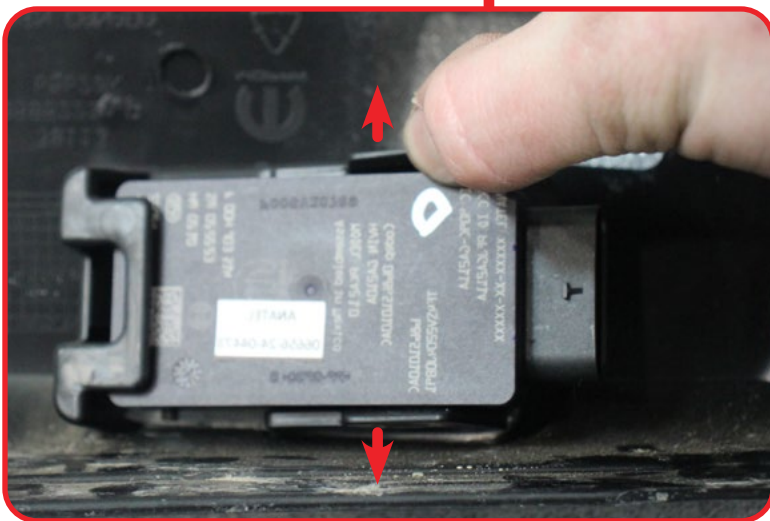
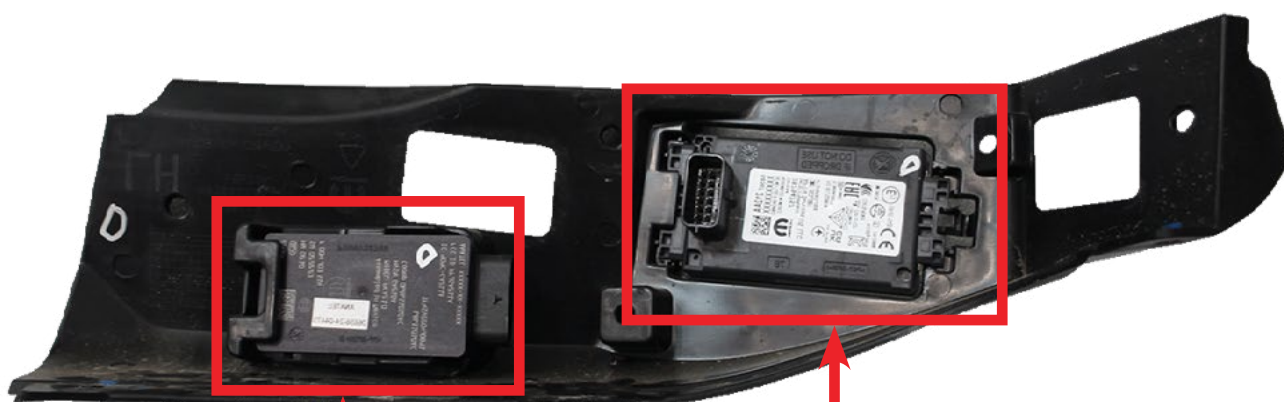

BOMBER REAR BUMPER

2025-UP/RAM RHO

REMOVAL

STEP 10

Remove the trailer plug in by pushing in on the tab shown below and pulling.

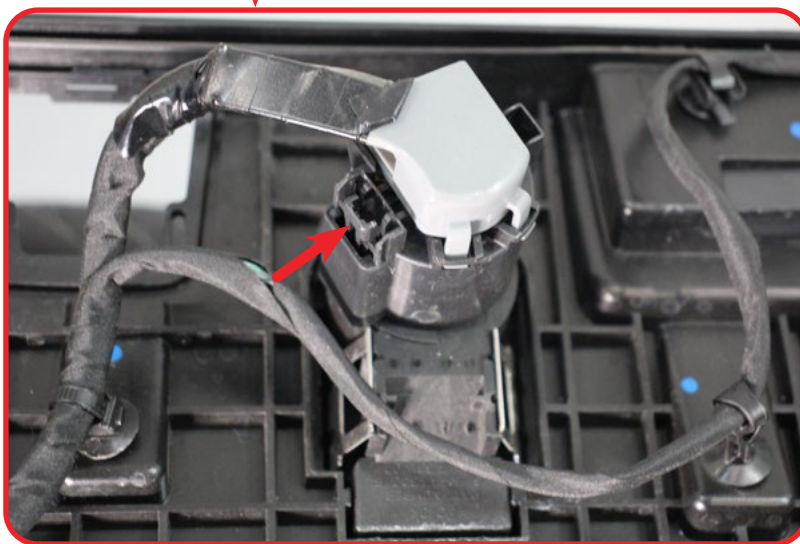
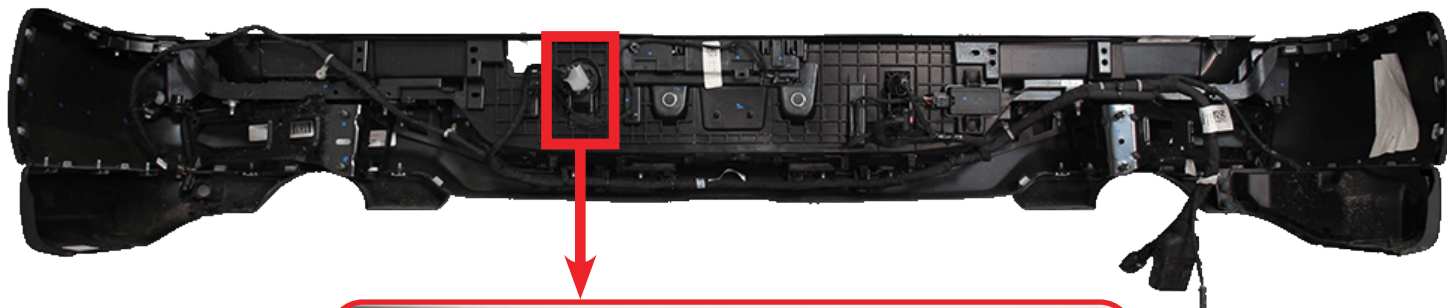

BOMBER REAR BUMPER

2025-UP/RAM RHO

REMOVAL

□ STEP 11

Using a (flathead screwdriver) remove the trailer plug by decompressing the metal tabs in on both sides.

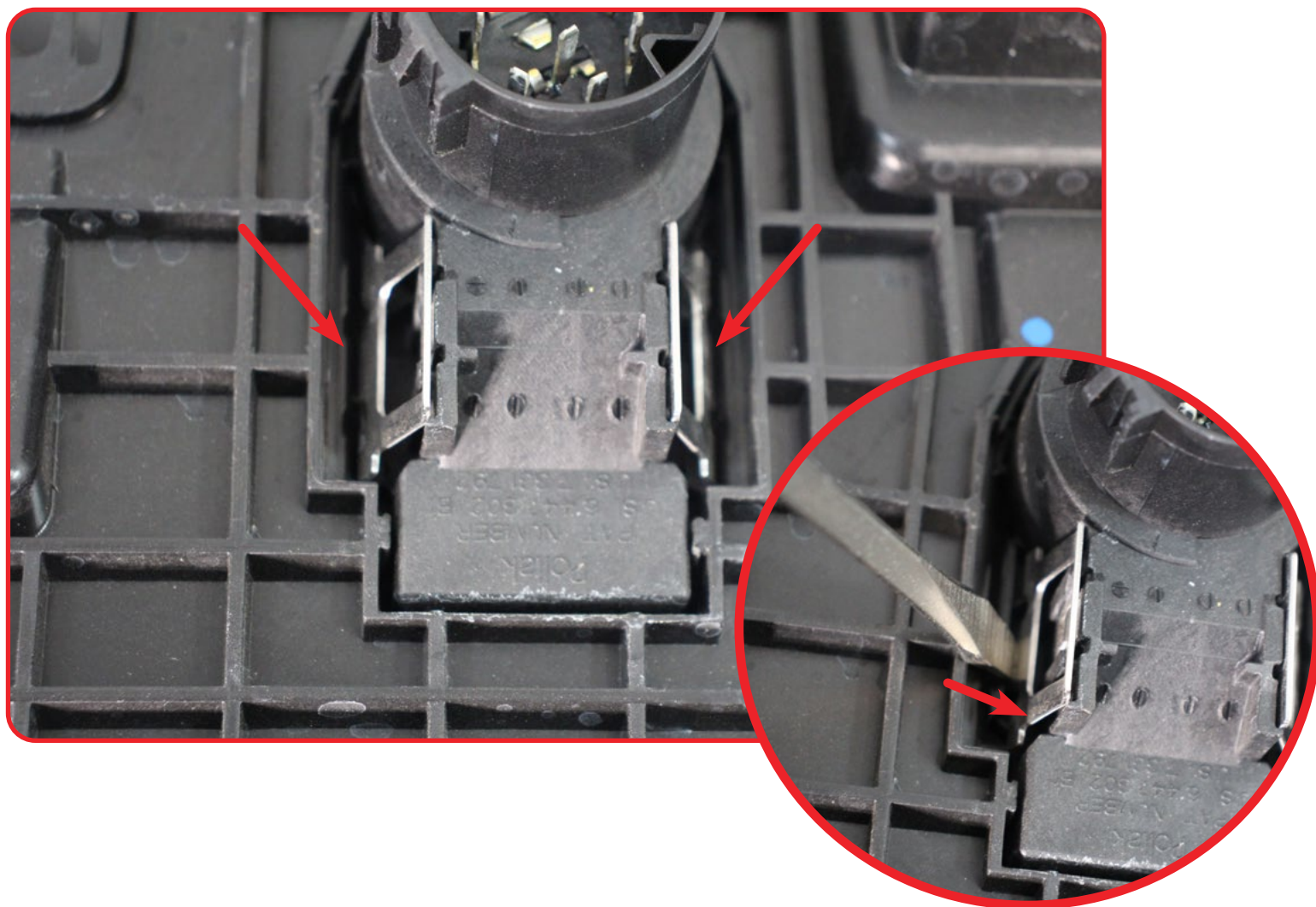
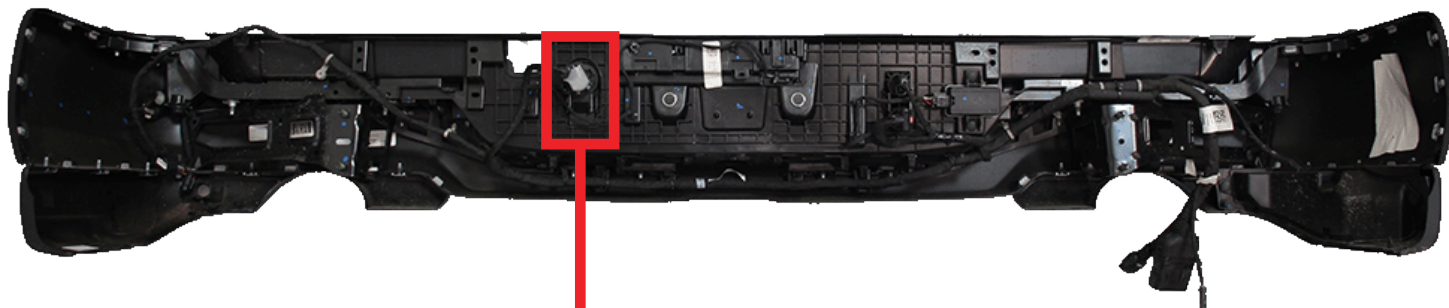

BOMBER REAR BUMPER

2025-UP/RAM RHO

REMOVAL

□ STEP 12

Unplug the trailer camera plugin as shown below.

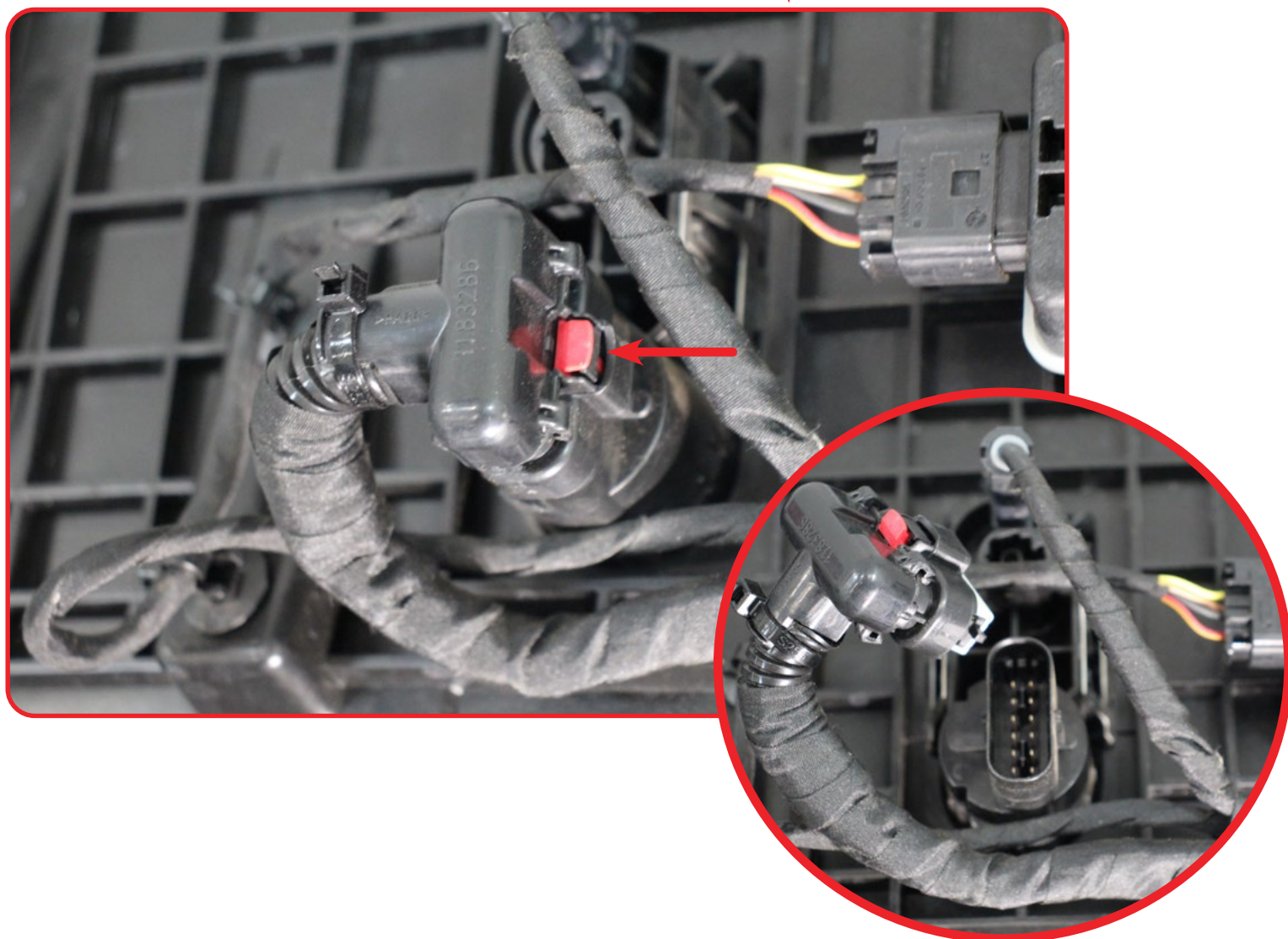
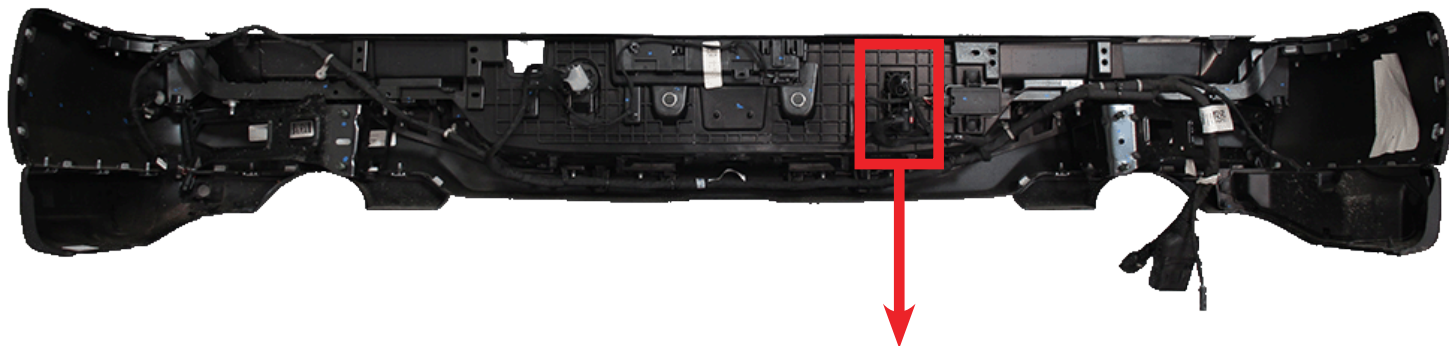

BOMBER REAR BUMPER

2025-UP/RAM RHO

REMOVAL

□ STEP 13

Remove the camera plug in by pressing on the black tab highlighted below.

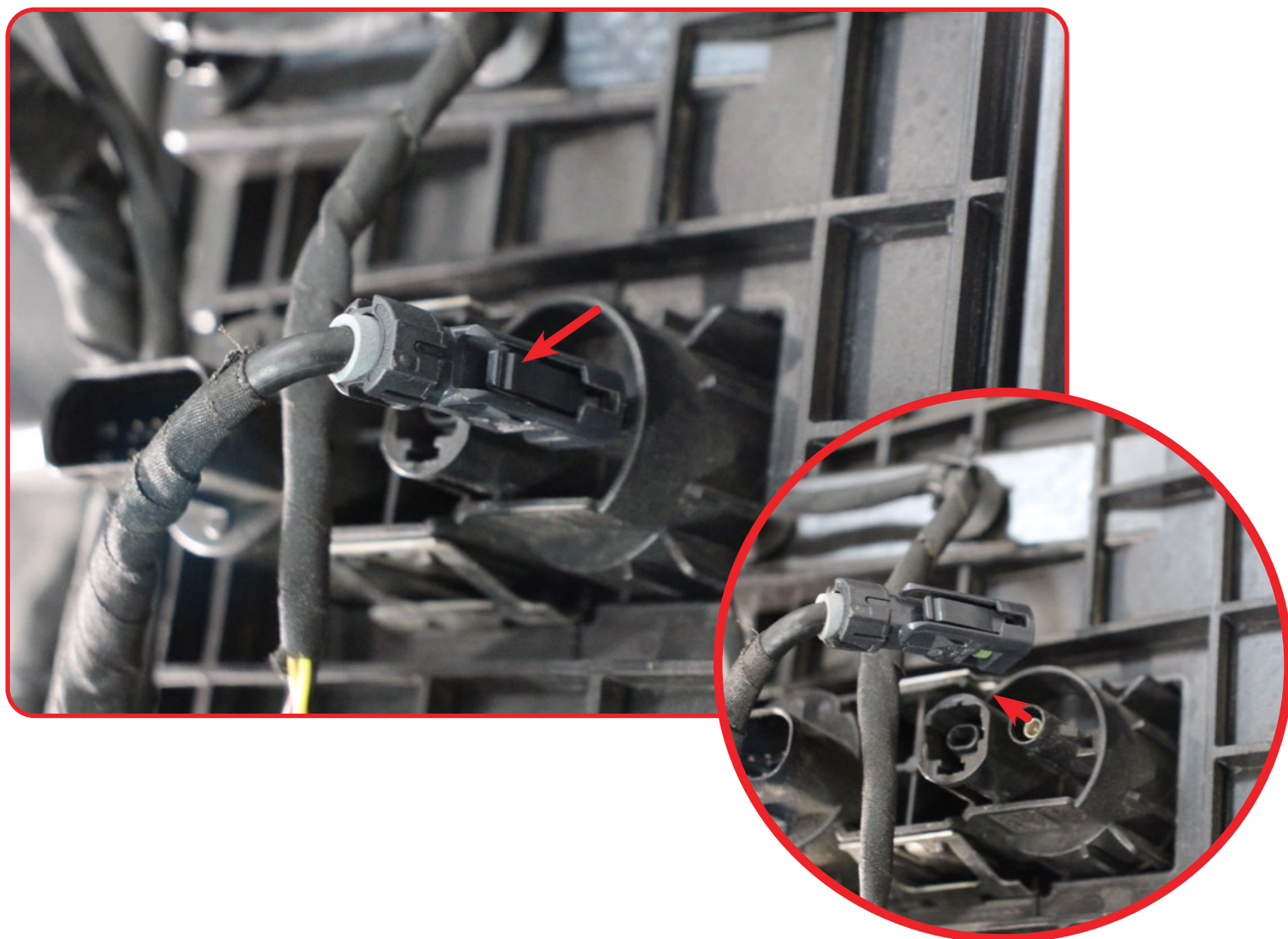
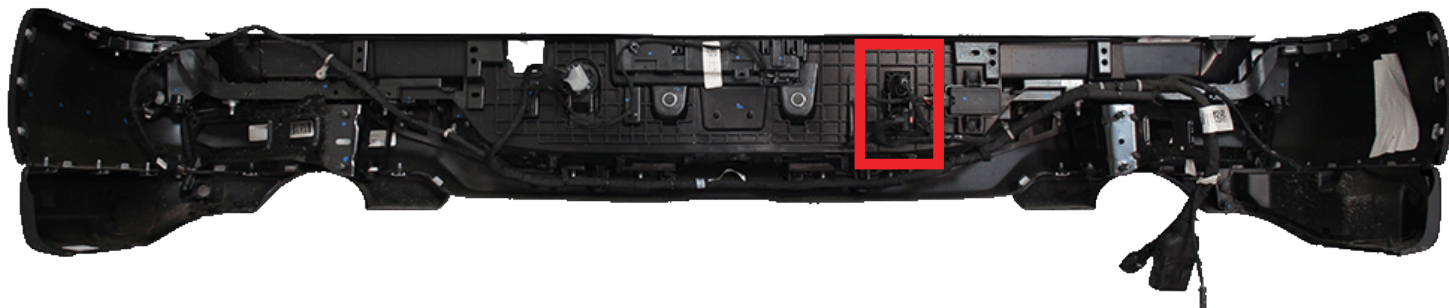



INSTALLATION GUIDE

BOMBER REAR BUMPER 2025-UP/RAM RHO

REMOVAL

❑ STEP 14

Disconnect the sensor shown below.

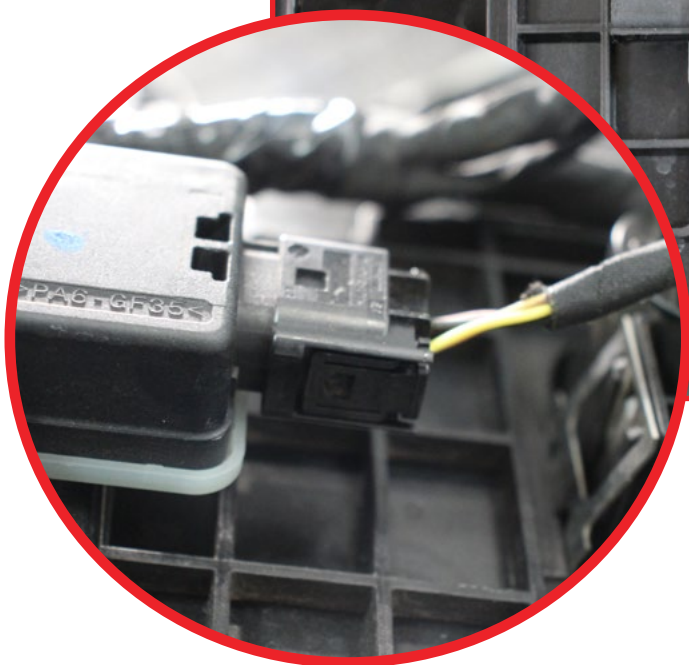
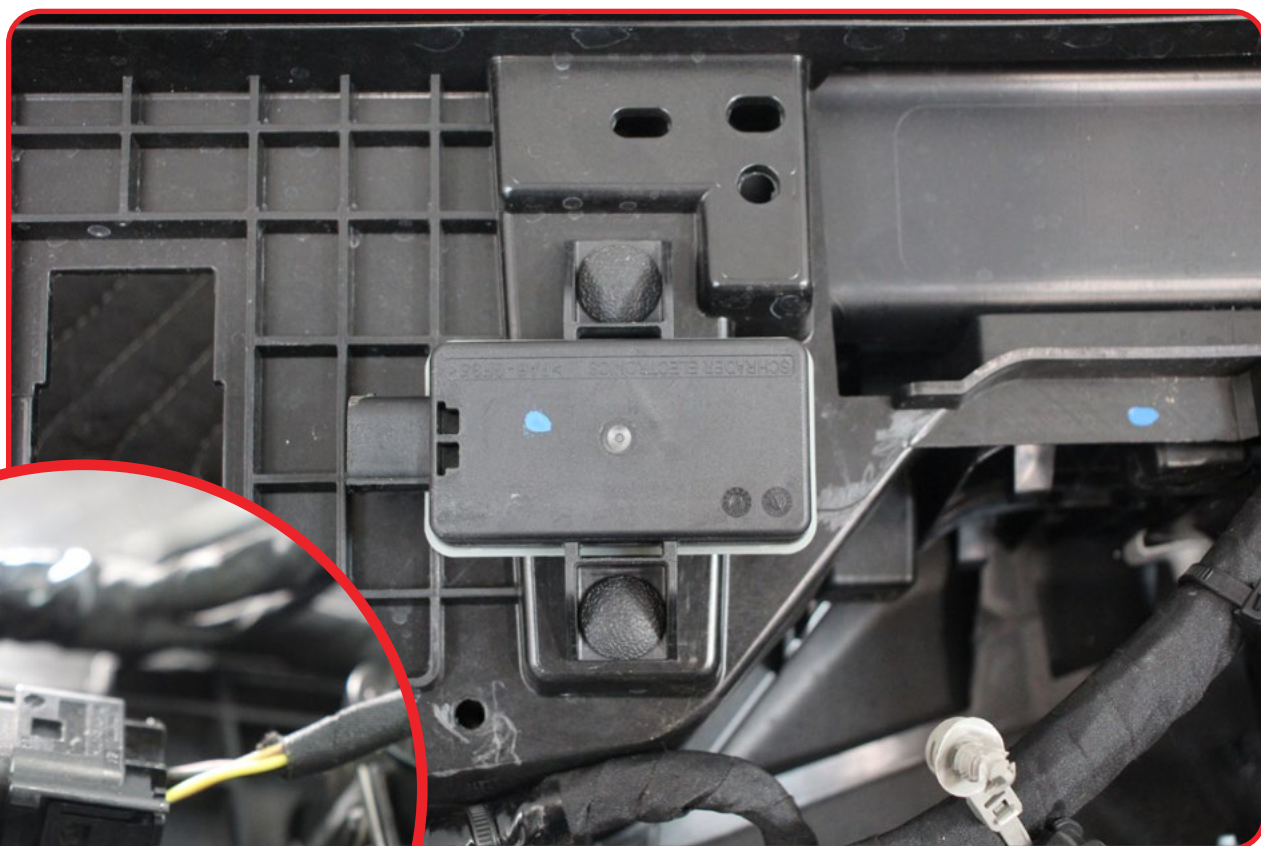
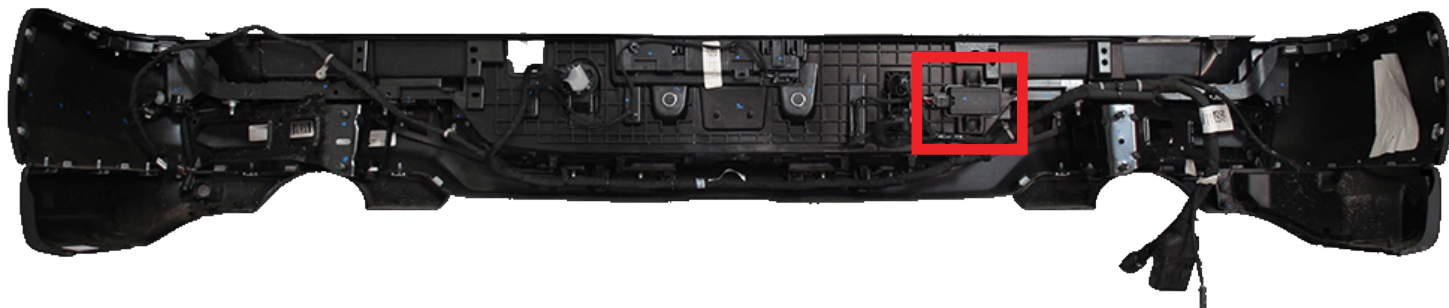



INSTALLATION GUIDE

BOMBER REAR BUMPER 2025-UP/RAM RHO

REMOVAL

□ STEP 15

Using a (fastener removal tool) remove the sensor shown below. ****Plug back into wire harness once removed****

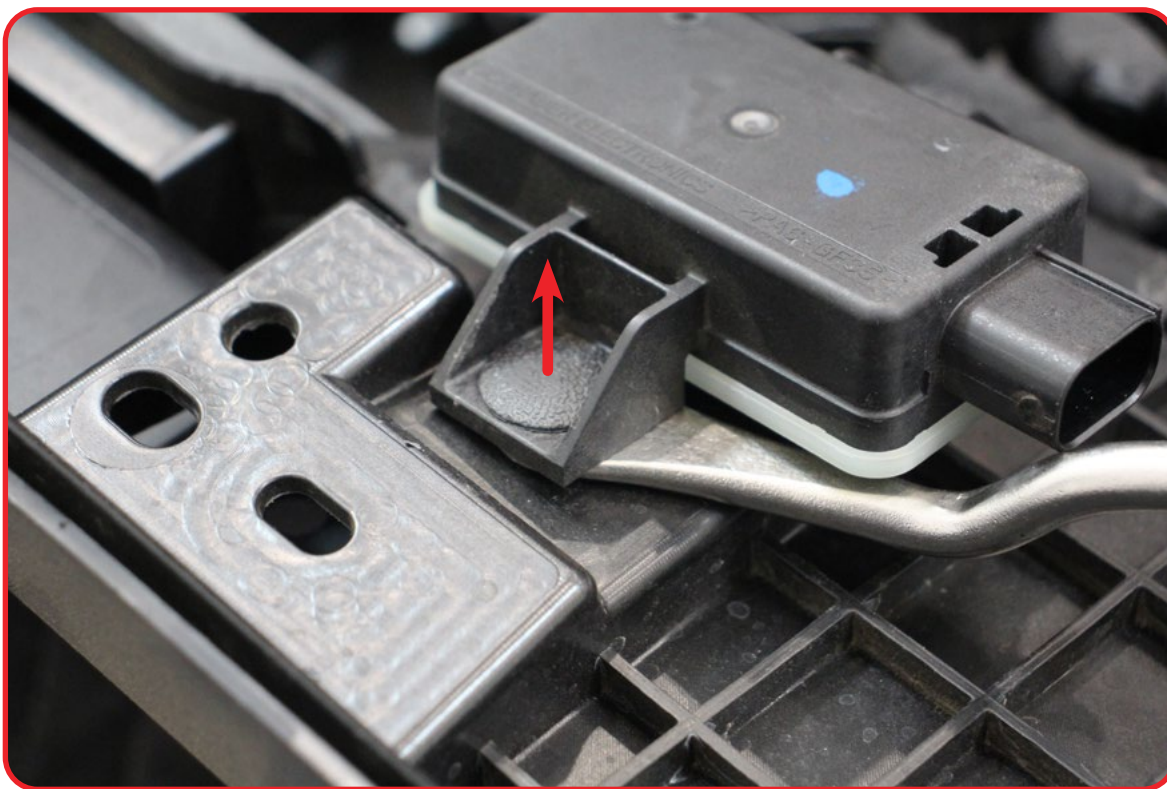
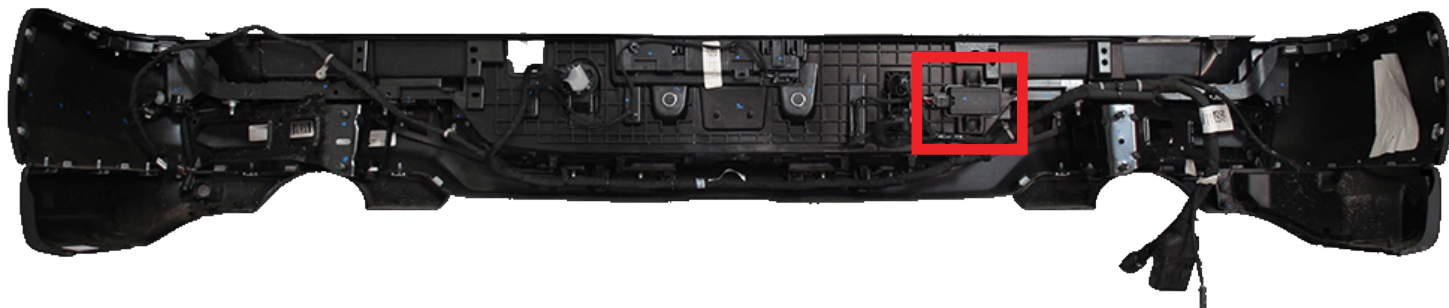

BOMBER REAR BUMPER

2025-UP/RAM RHO

REMOVAL

□ STEP 16

Using a (fastener removal tool) remove the trees shown below and any remaining trees on the bumper at this time.

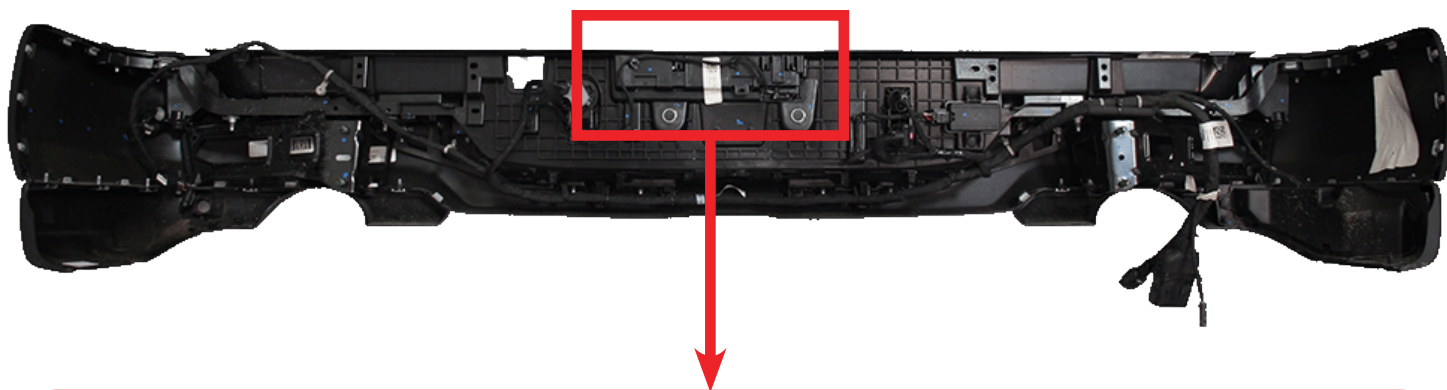

BOMBER REAR BUMPER

2025-UP/RAM RHO

REMOVAL

□ STEP 17

Unplug the keyless antenna by pushing the purple tab up and pressing down and pulling as shown below.

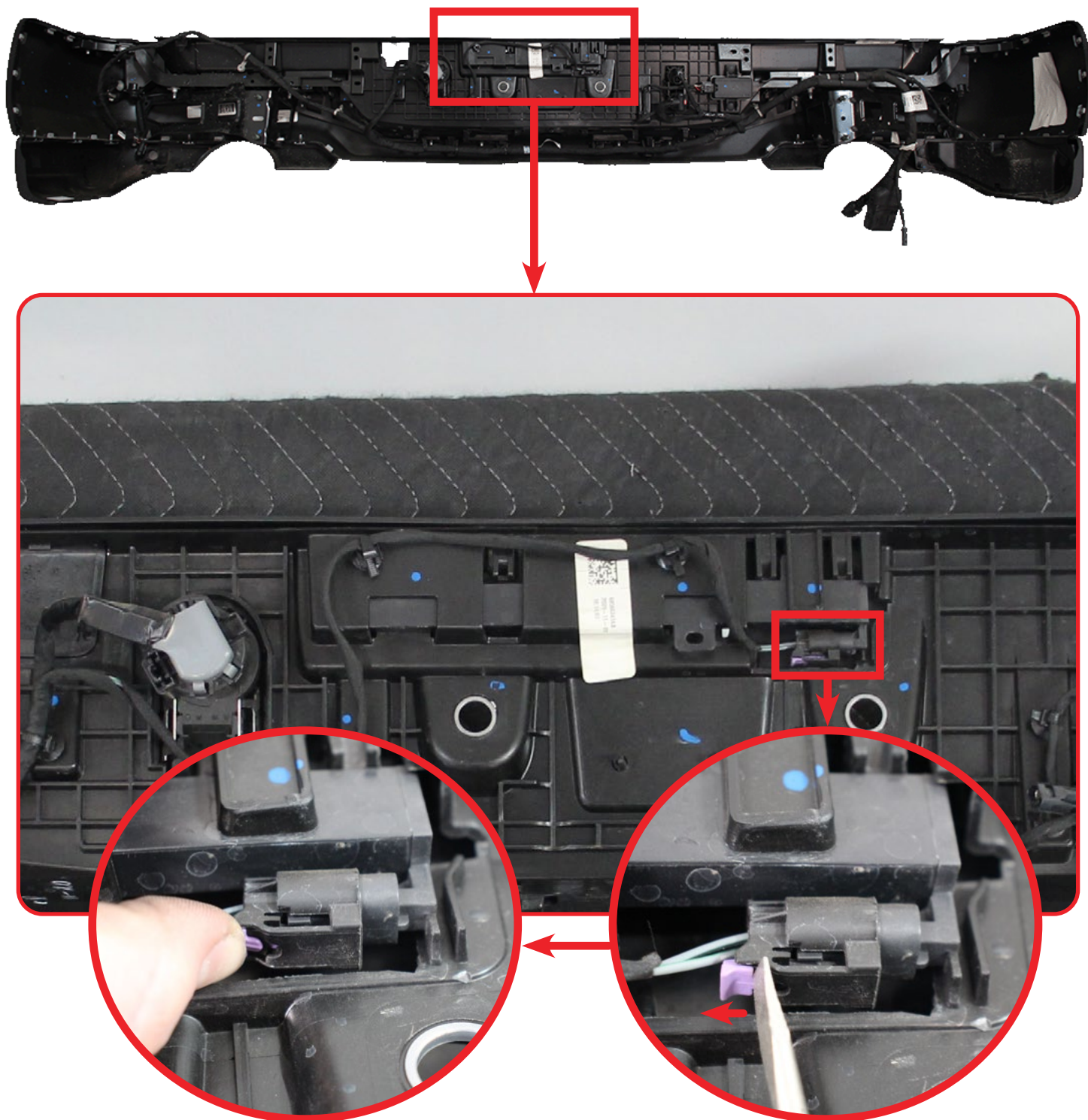

BOMBER REAR BUMPER 2025-UP/RAM RHO

REMOVAL

STEP 18

With a (flathead screwdriver) pry up the tabs highlighted below.

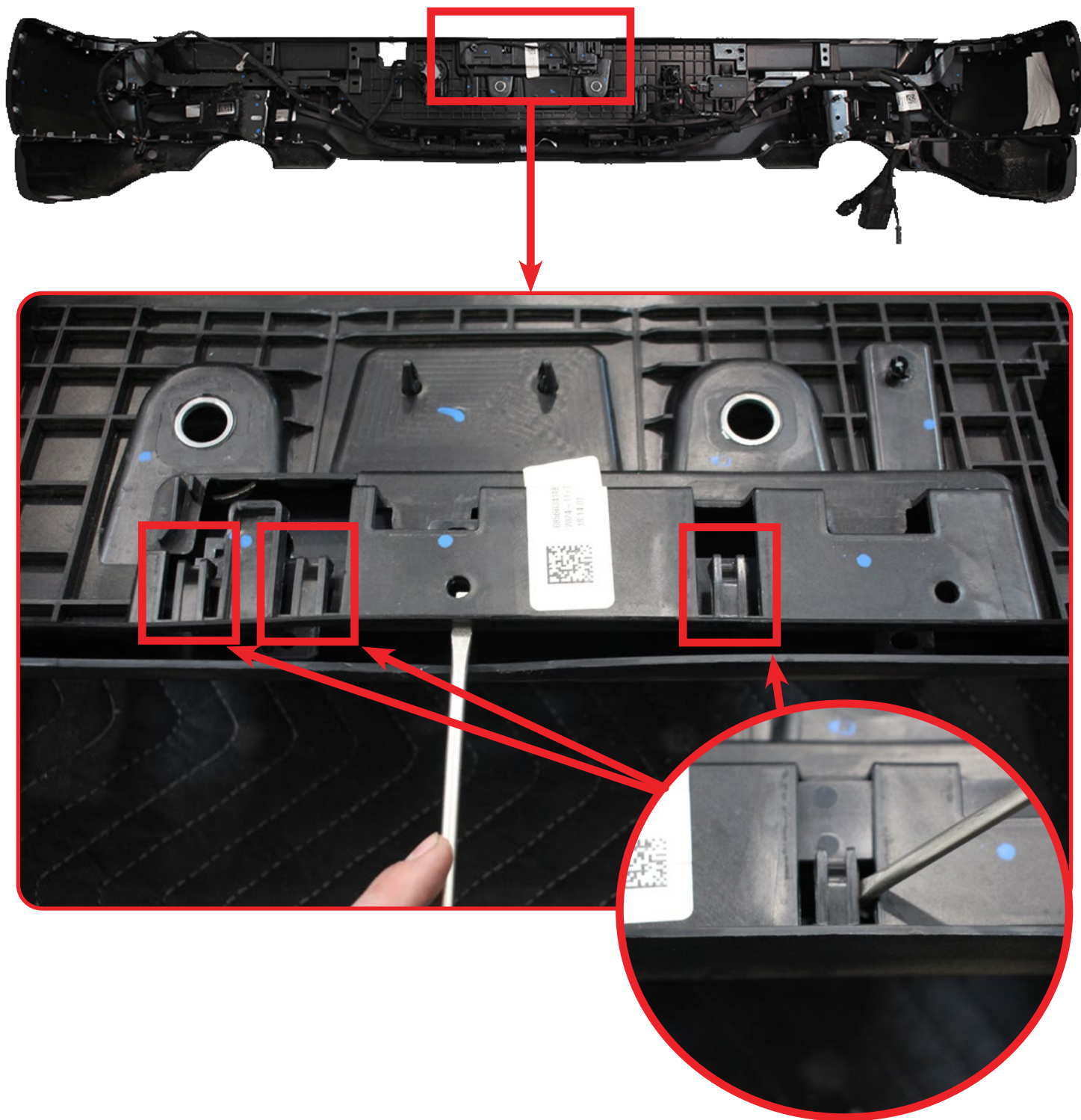

BOMBER REAR BUMPER

2025-UP/RAM RHO

REMOVAL

□ STEP 19

Using a (flathead screwdriver) pry between the front plastic and rear plastic to pull out the keyless antenna as shown below. ****Plug back into wire harness once removed****

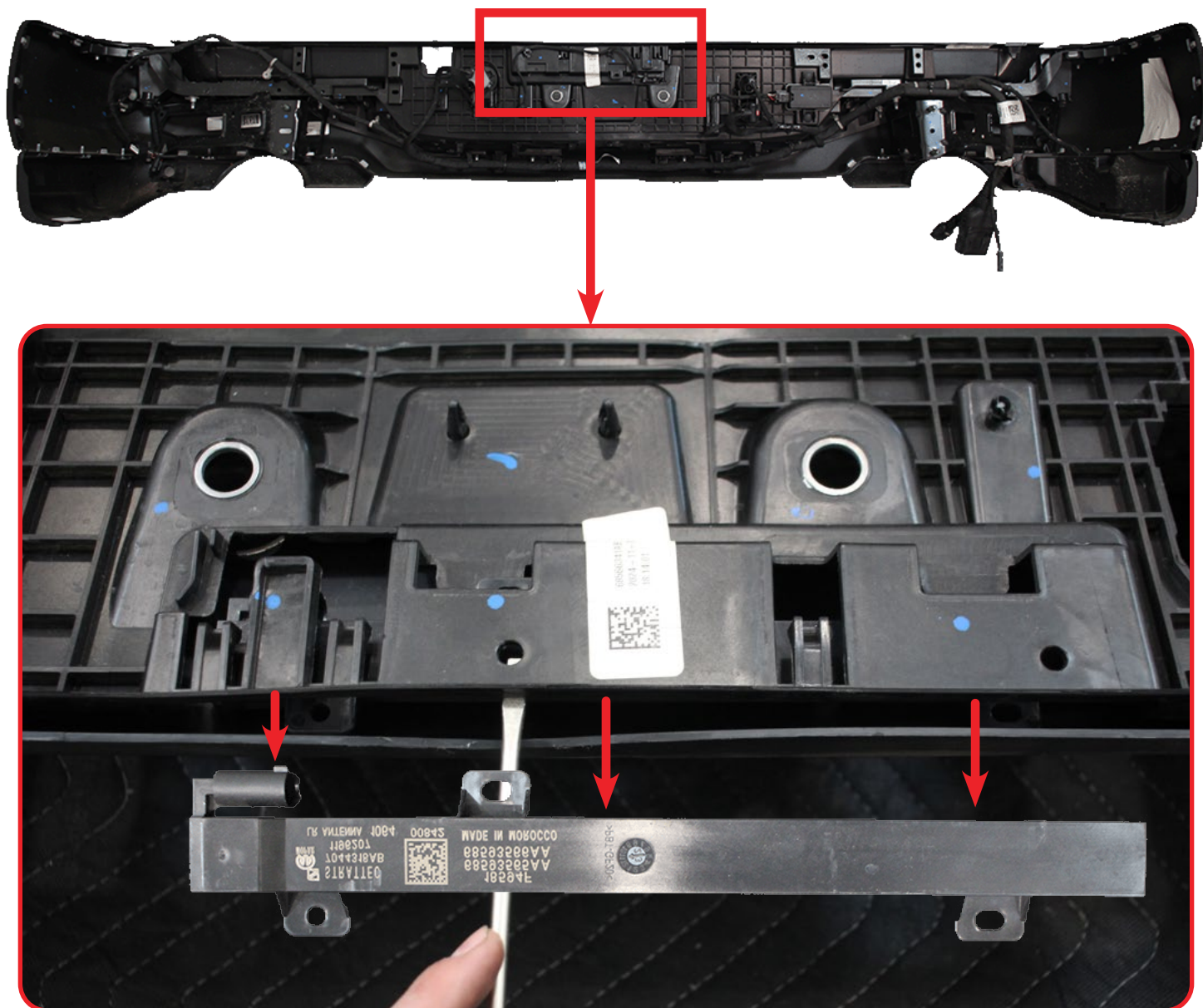

BOMBER REAR BUMPER 2025-UP/RAM RHO

REMOVAL

□ STEP 20

Remove all parking sensors from the bezels, ****DO NOT PULL FROM WIRES DUE TO DE PINNING****

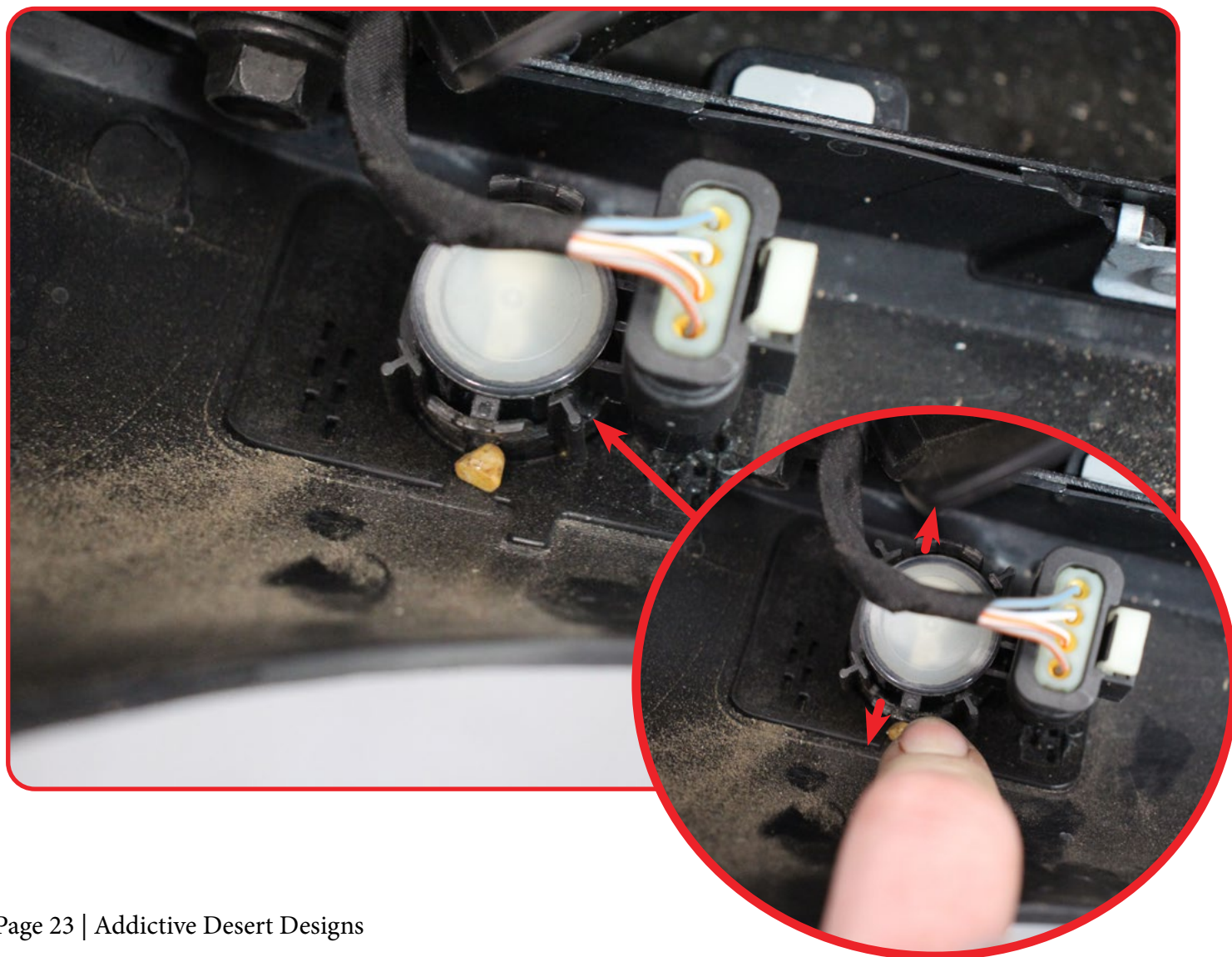
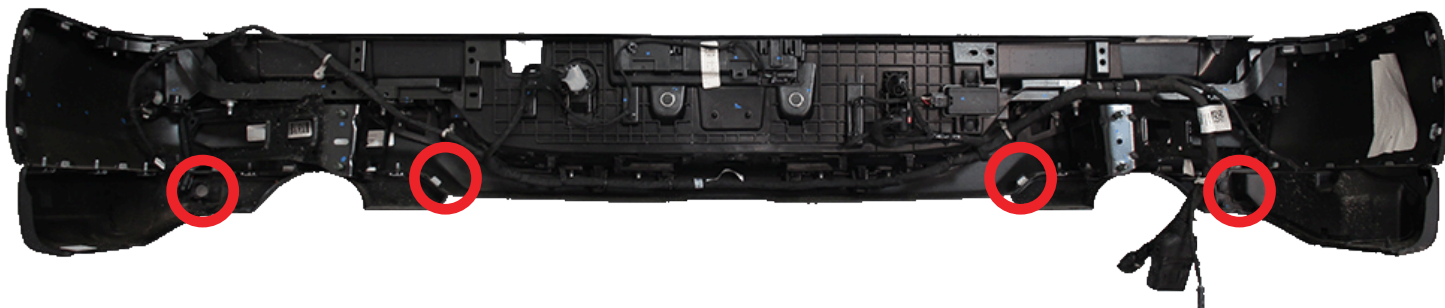



INSTALLATION GUIDE

BOMBER REAR BUMPER

2025-UP/RAM RHO

REMOVAL

□ STEP 21

Unplug the license plate light as shown below on both driver and passenger side.

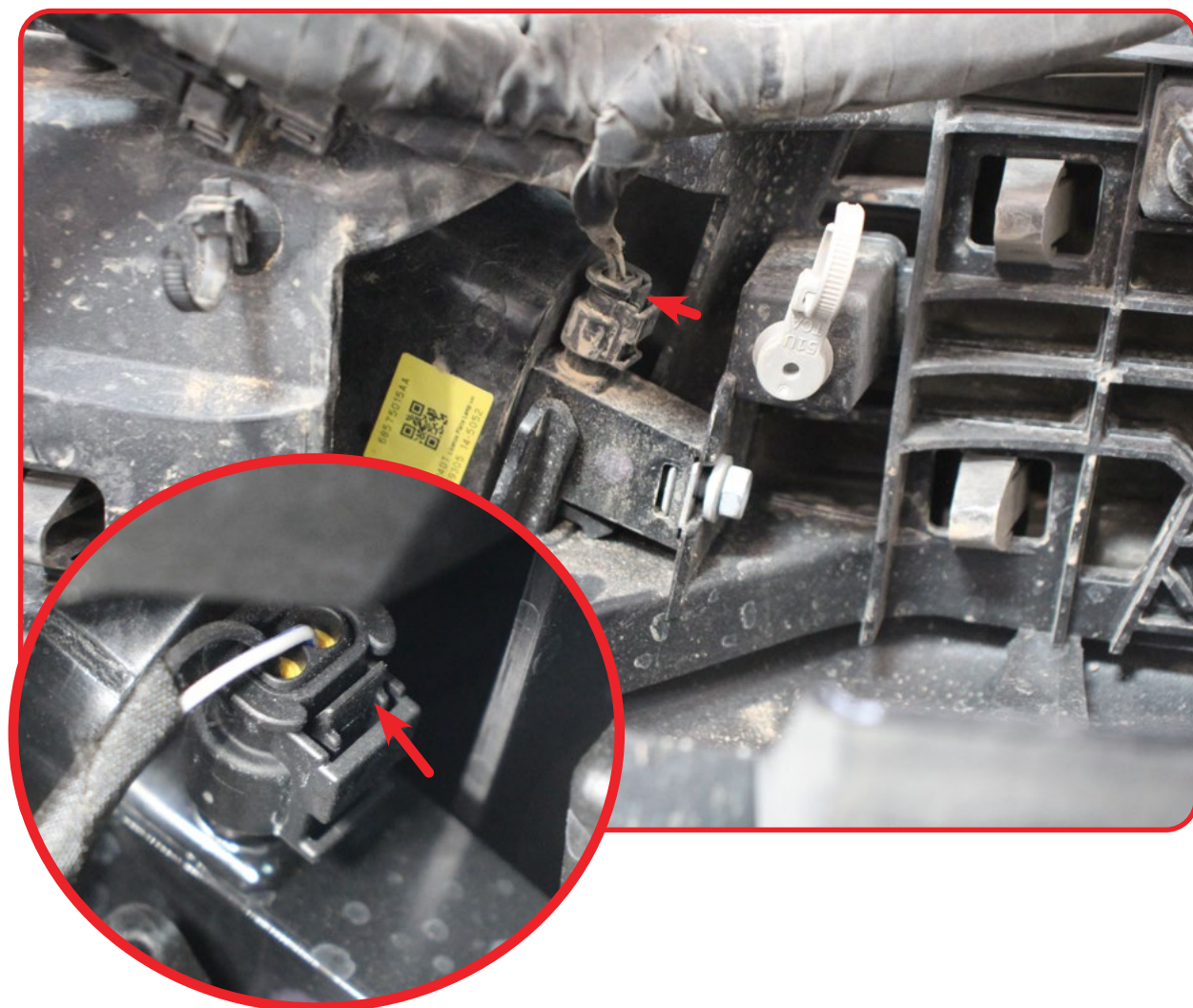
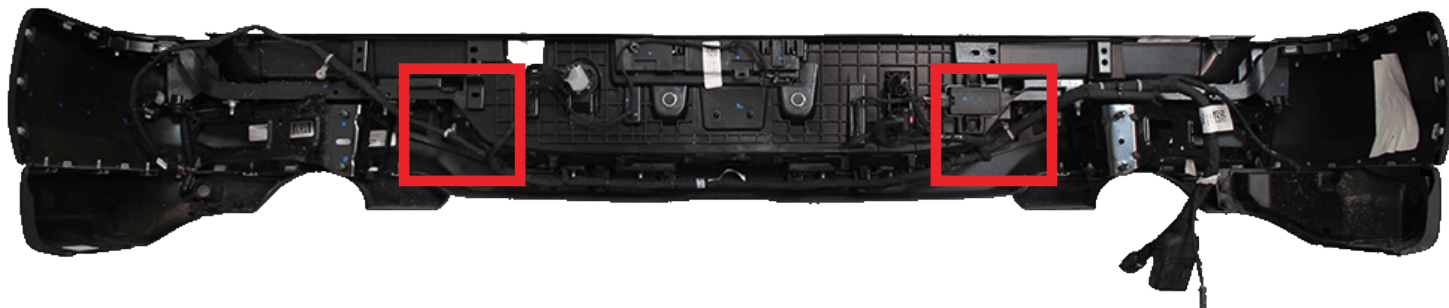

BOMBER REAR BUMPER

2025-UP/RAM RHO

REMOVAL

□ STEP 22

Using a (10mm socket) remove the hardware holding the license plate lights. ****KEEP HARDWARE****

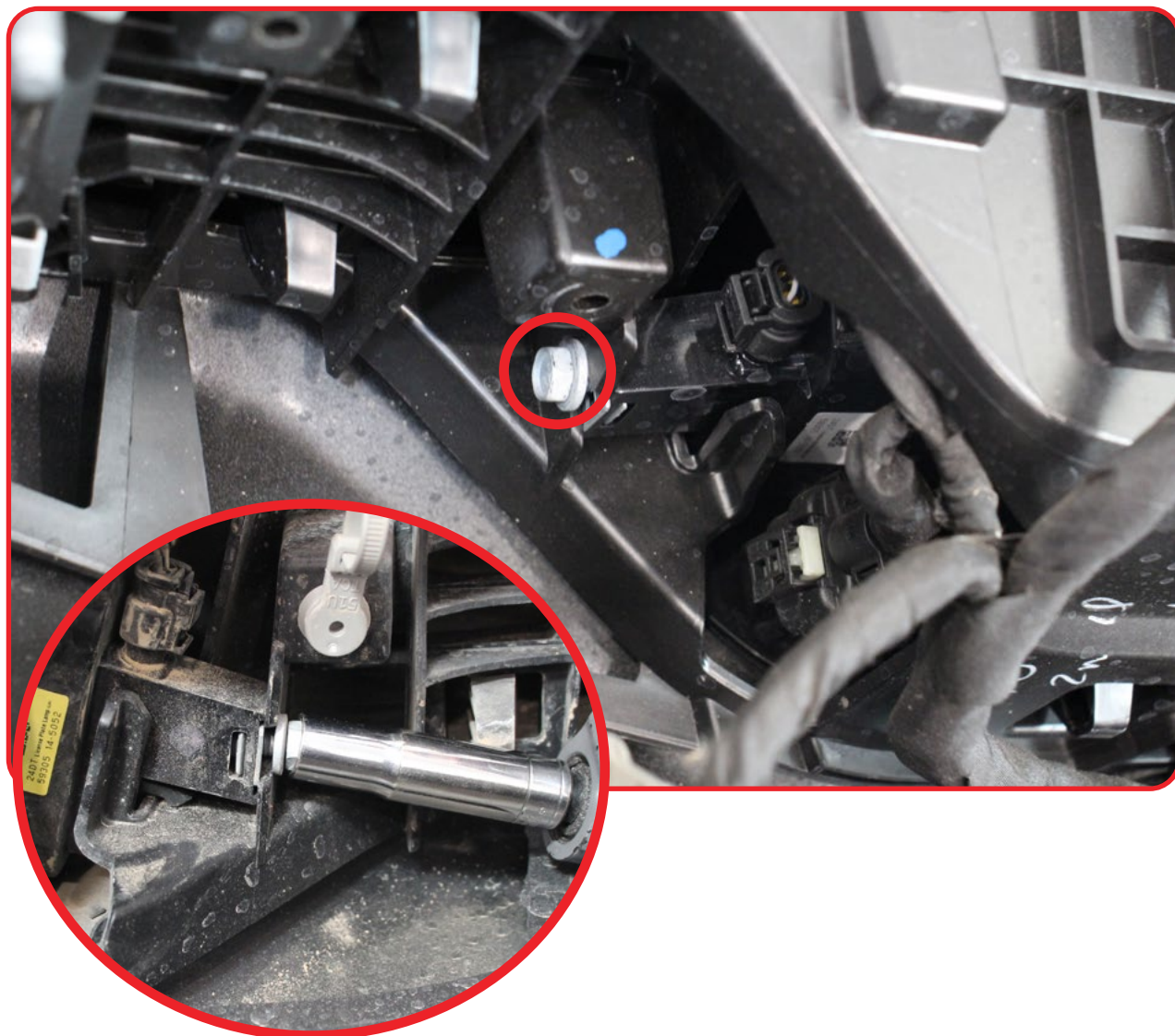
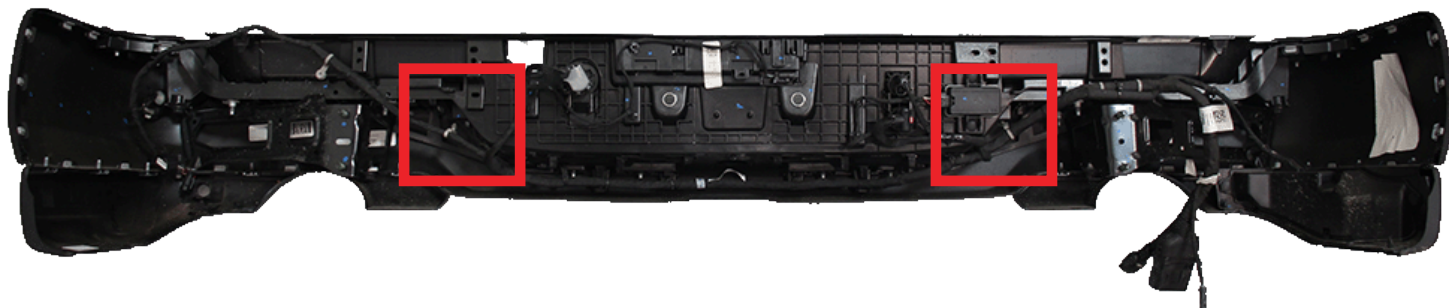

BOMBER REAR BUMPER

2025-UP/RAM RHO

REMOVAL

□ STEP 23

Using your choice of cutting tools, cut the support bracket on the hitch and paint to prevent rust.

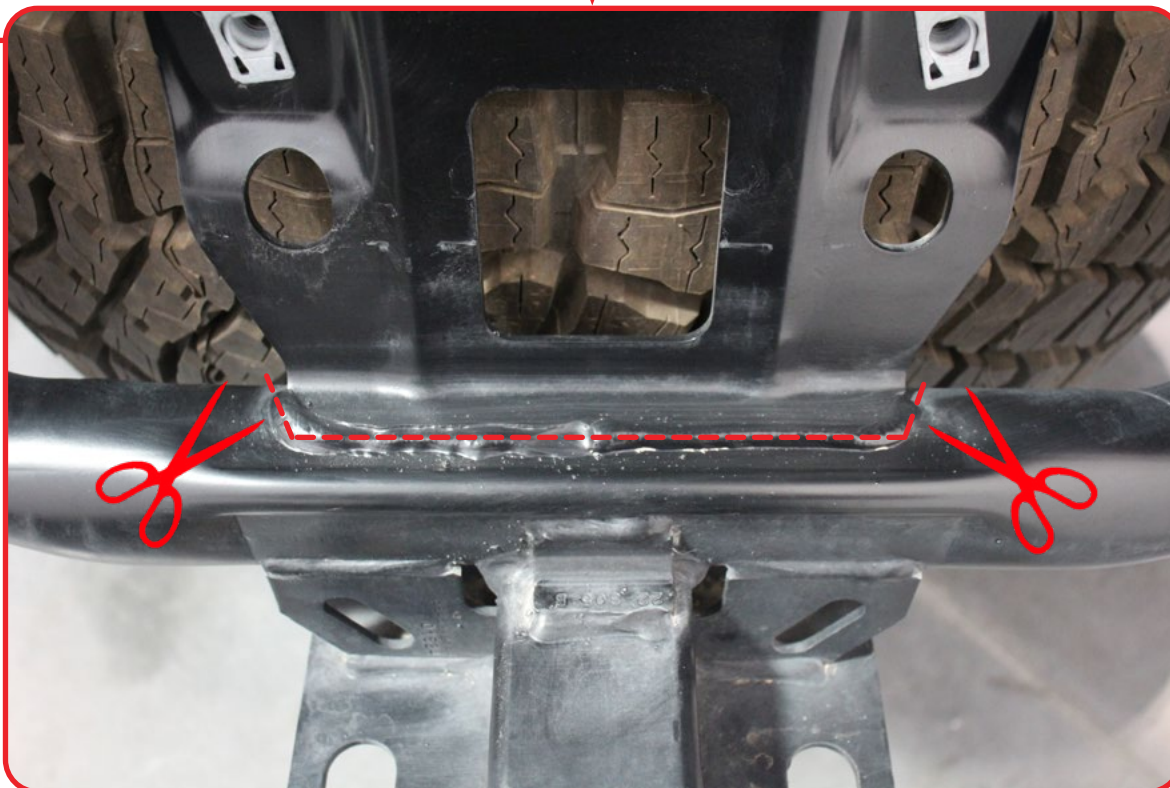
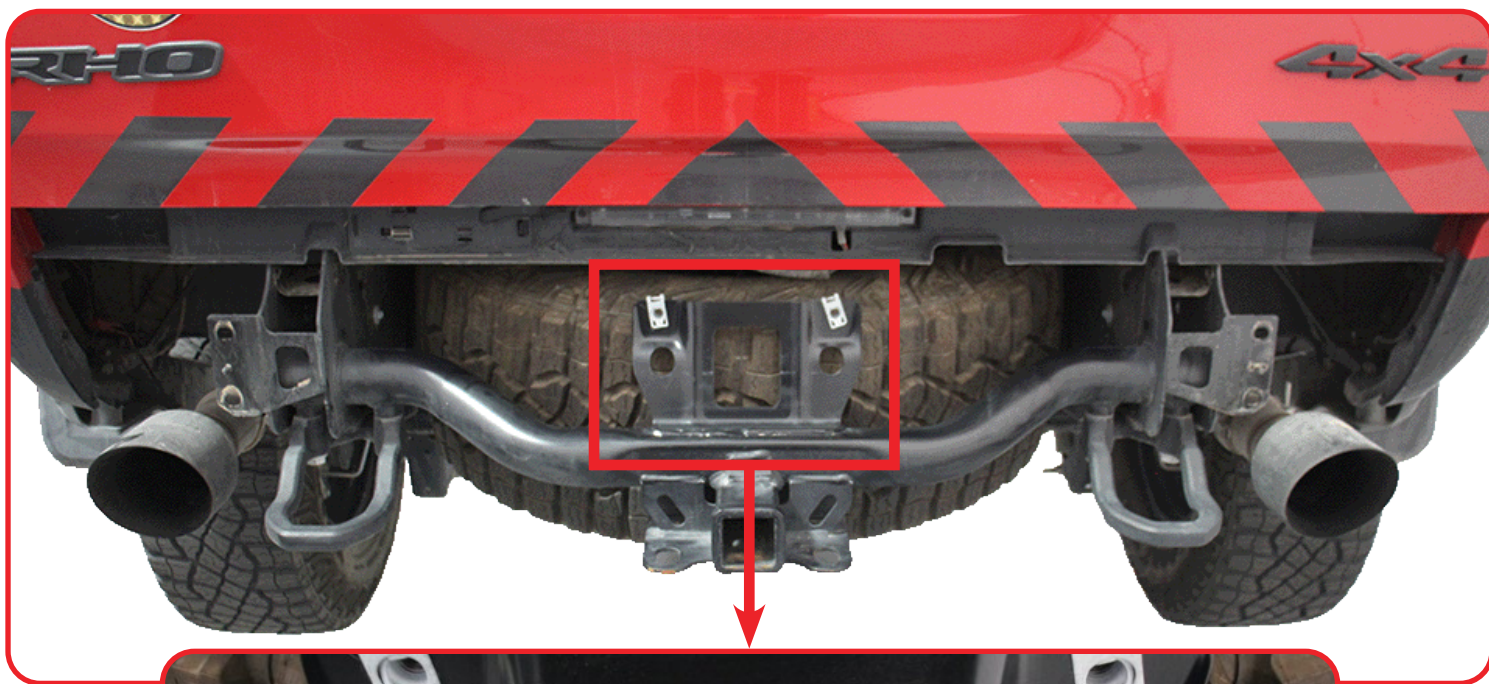



INSTALLATION GUIDE

BOMBER REAR BUMPER

2025-UP/RAM RHO

INSTALL

□ STEP 24

Install the license plate lights with the provided (I) brackets with the hardware removed from step 22 using a (10mm wrench).

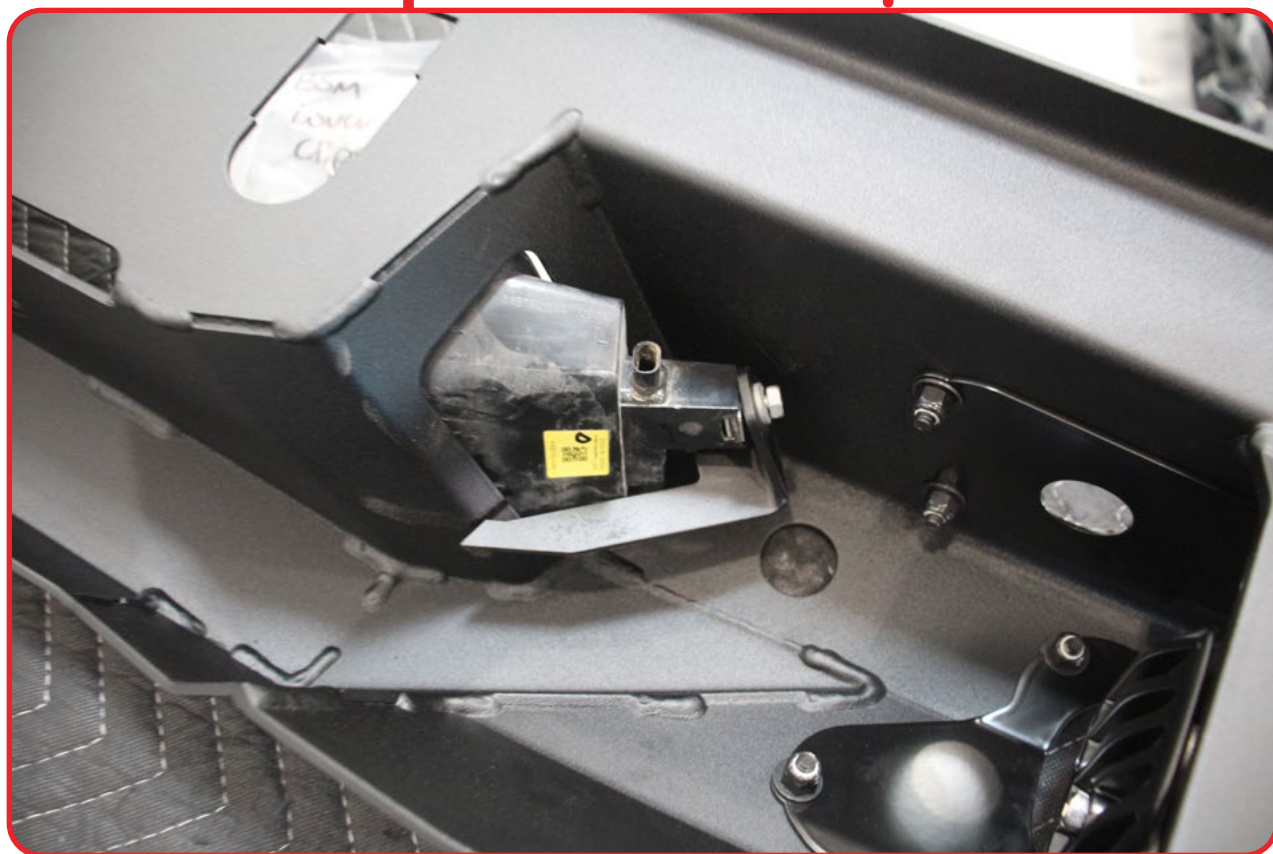
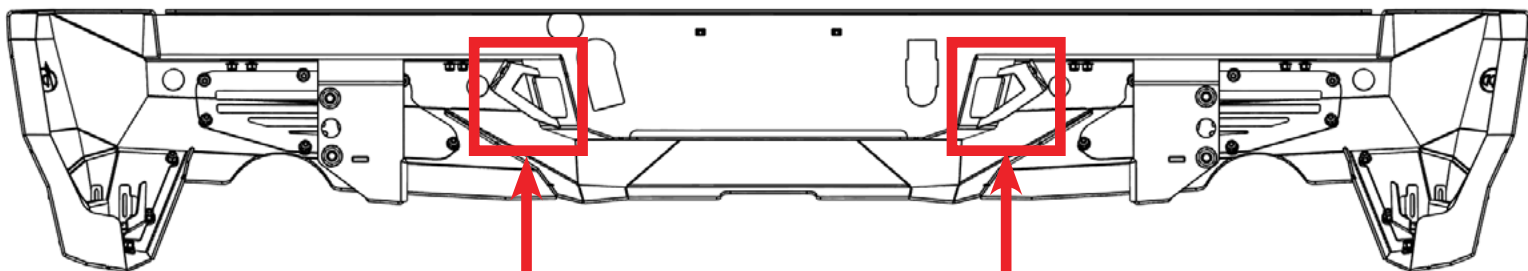

BOMBER REAR BUMPER

2025-UP/RAM RHO

INSTALL

□ STEP 25

Install the trailer camera plug into the cutout highlighted below. Use a (flathead screwdriver) to pry the tabs outwards.

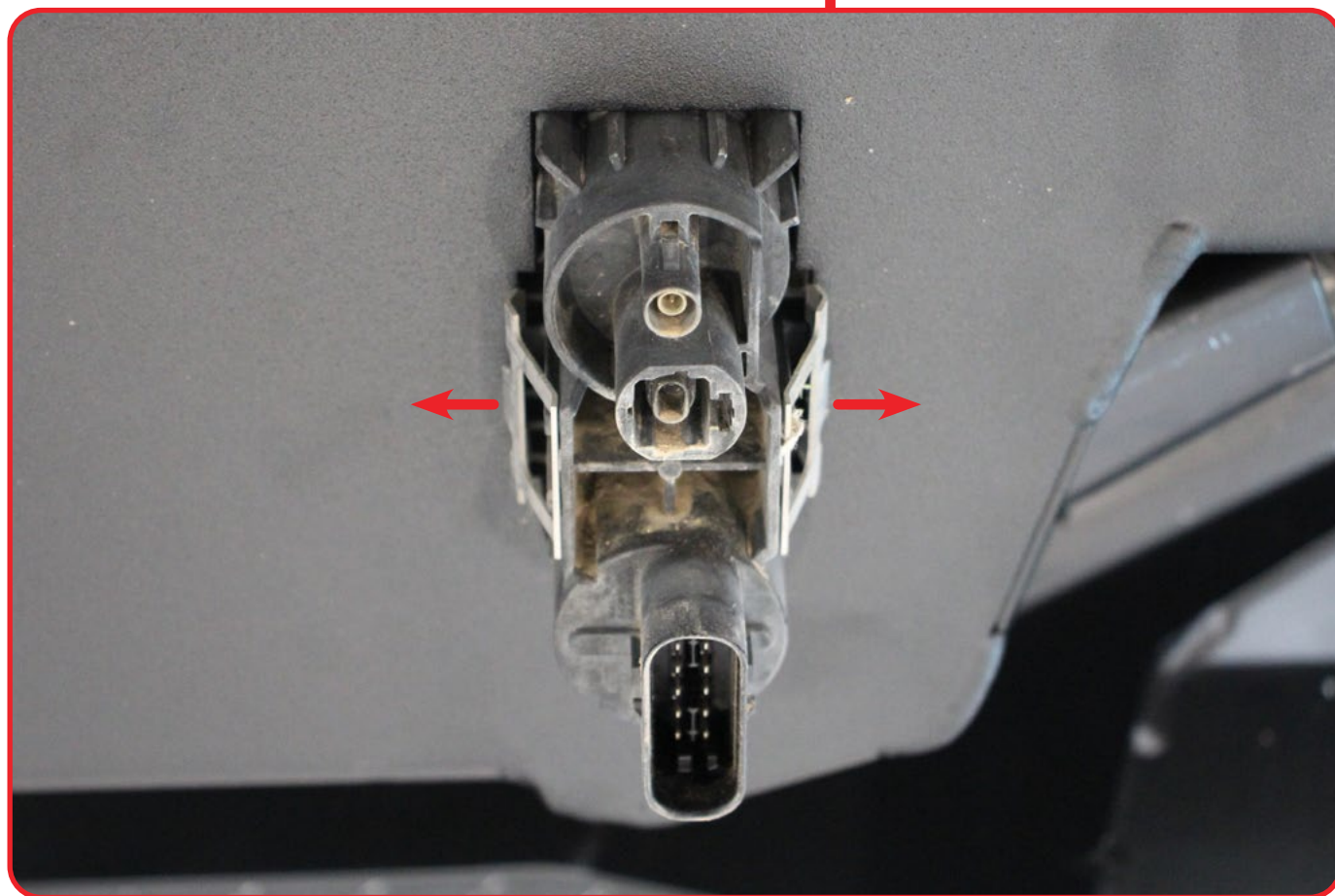
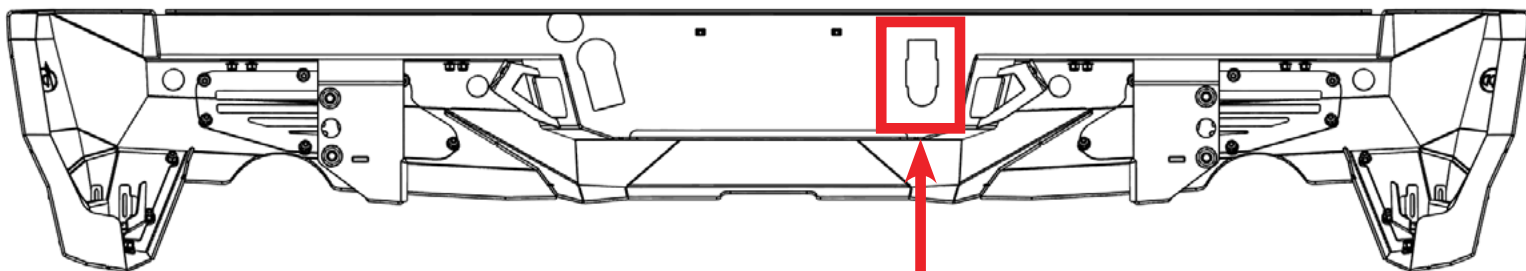



INSTALLATION GUIDE

BOMBER REAR BUMPER

2025-UP/RAM RHO

INSTALL

□ STEP 26

Install the trailer plug into the cutout highlighted below. Use a (flathead screwdriver) to pry the tabs outwards.

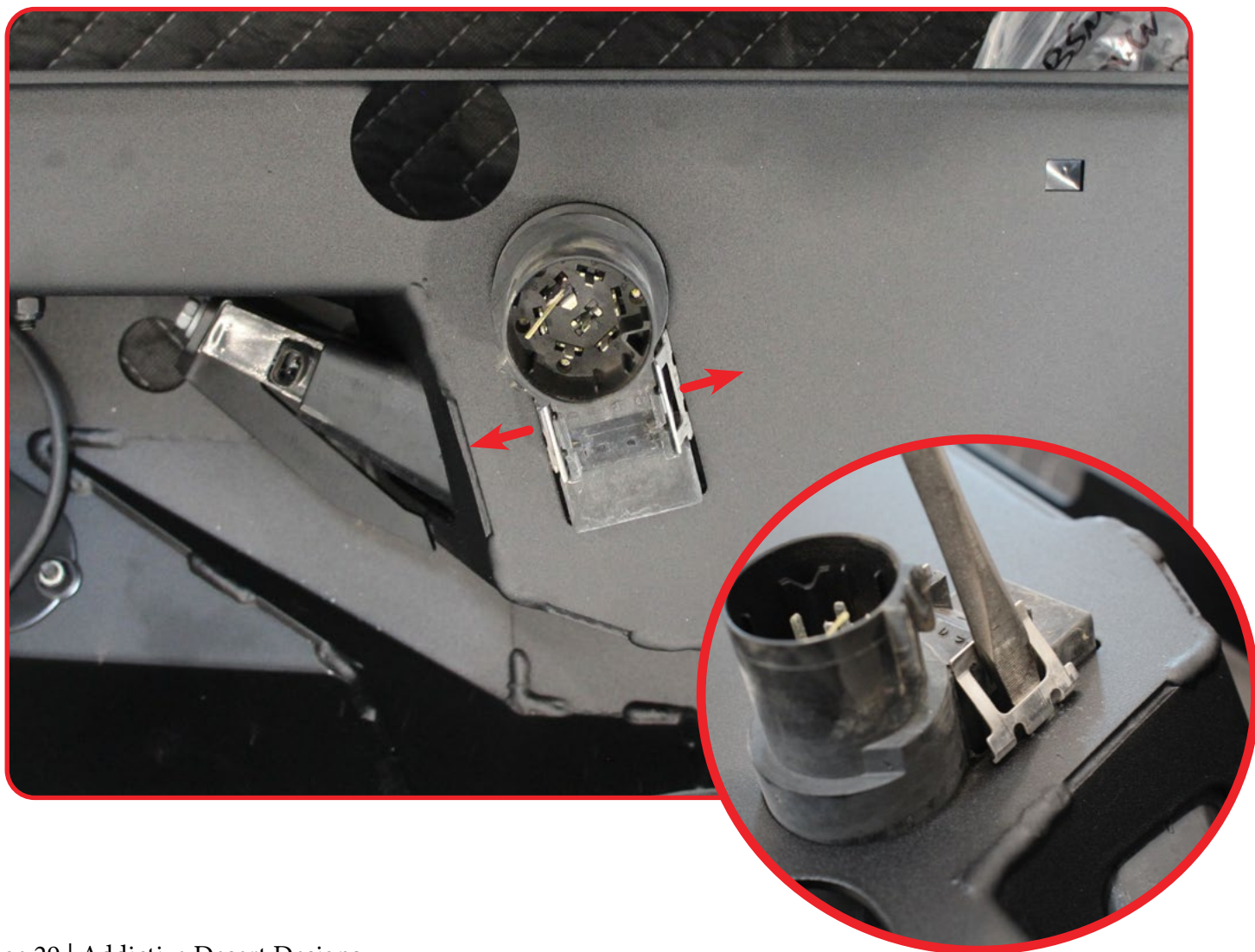
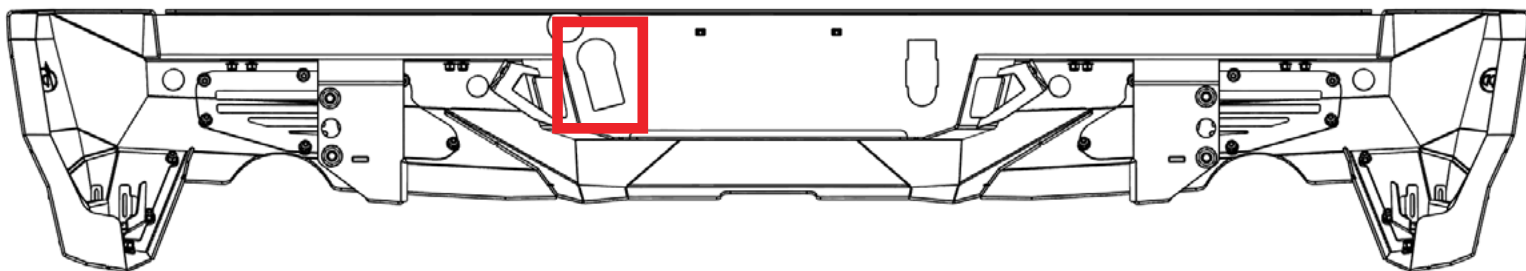

BOMBER REAR BUMPER

2025-UP/RAM RHO

INSTALL

□ STEP 27

Install the provided (D, D1) sensor bezels in the orientation shown below on the outer passenger sensor cutout.

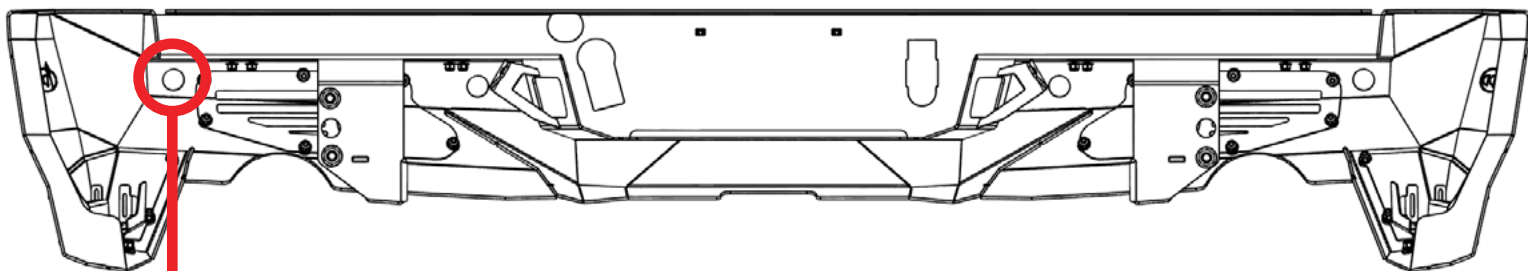

BOMBER REAR BUMPER

2025-UP/RAM RHO

INSTALL

□ STEP 28

Install the provided (D, D1) sensor bezels in the orientation shown below on the inner passenger sensor cutout.

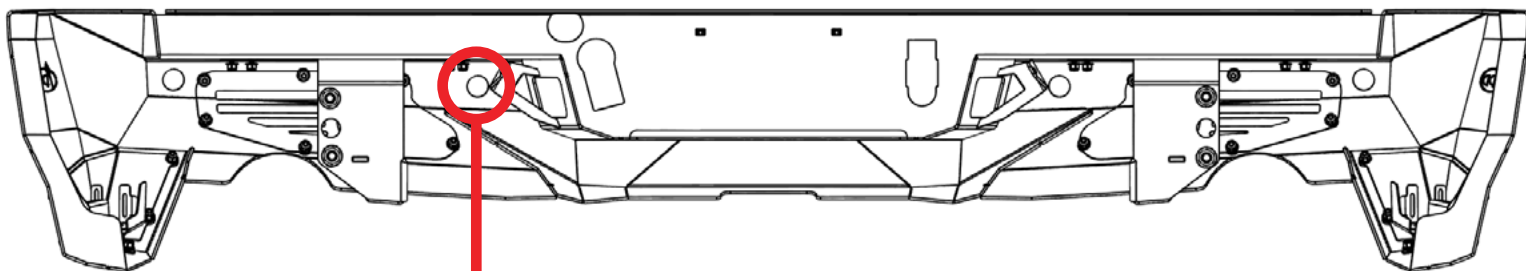

BOMBER REAR BUMPER

2025-UP/RAM RHO

INSTALL

□ STEP 29

Install the provided (D, D1) sensor bezels in the orientation shown below on the inner driver sensor cutout.

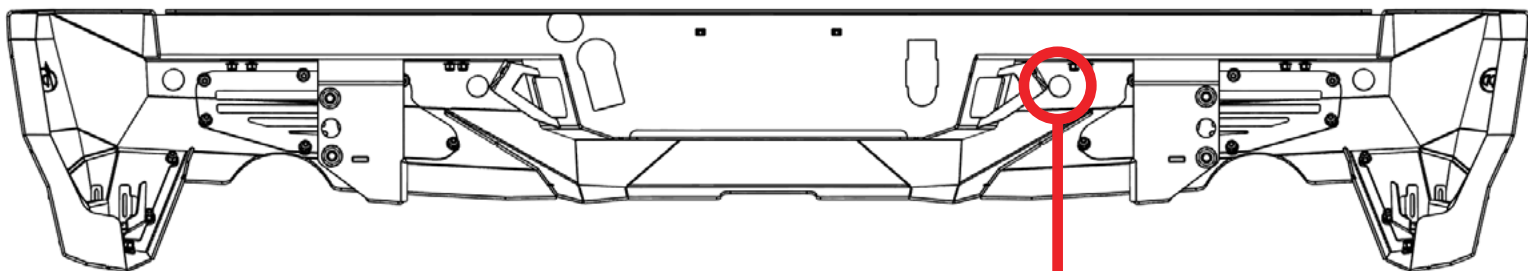



INSTALLATION GUIDE

BOMBER REAR BUMPER

2025-UP/RAM RHO

INSTALL

□ STEP 30

Install the provided (D, D1) sensor bezels in the orientation shown below on the outer driver sensor cutout.

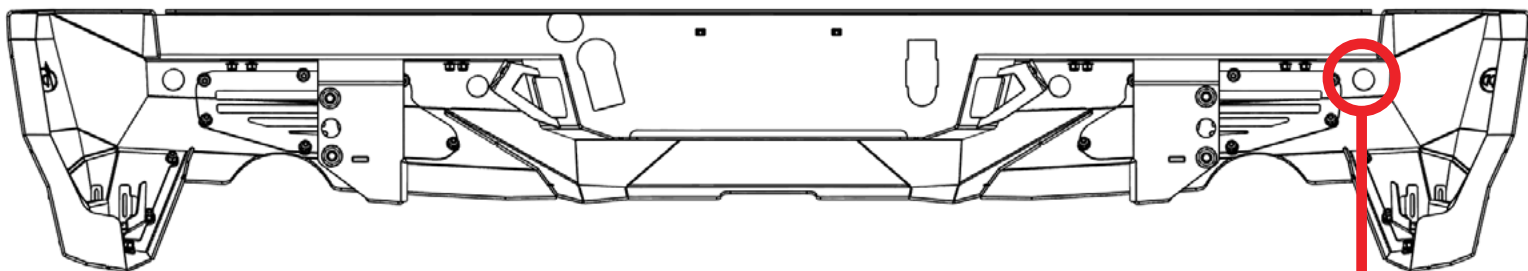



INSTALLATION GUIDE

BOMBER REAR BUMPER

2025-UP/RAM RHO

INSTALL

STEP 31

Install the (J, J1) plastic cover with the provided (A, A1, A2) 1/4" hardware using a (5/32 allen) and a (7/16 wrench). ****Leave out the crossed out bolt until later on in the install****

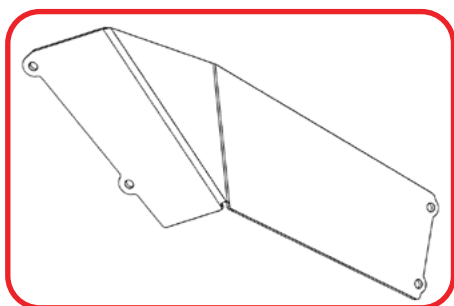
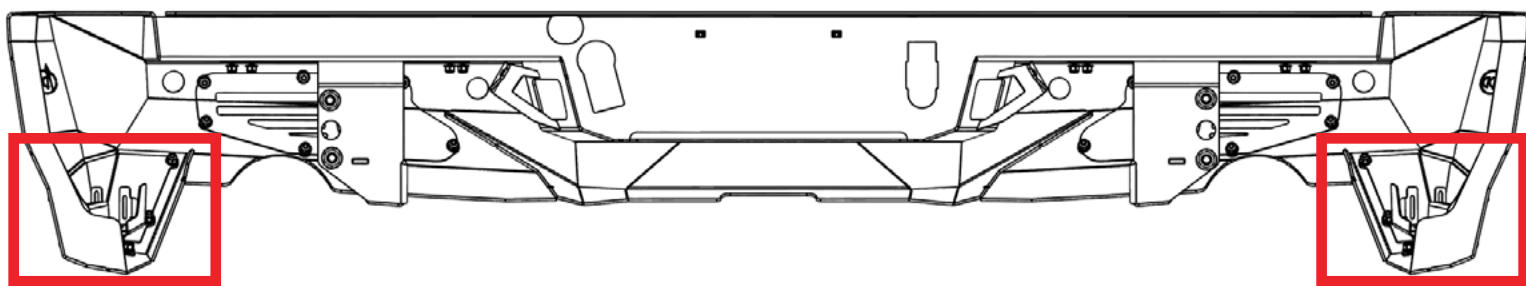

J.
J1.

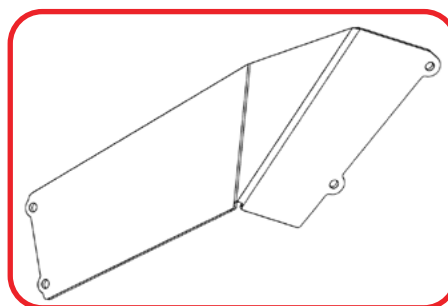

BOMBER REAR BUMPER

2025-UP/RAM RHO

INSTALL

□ STEP 32

Shown below is the Assembly of the BSM and mid range sensor brackets. Ensure to install in the order of 1-4 following **steps 33-35**.

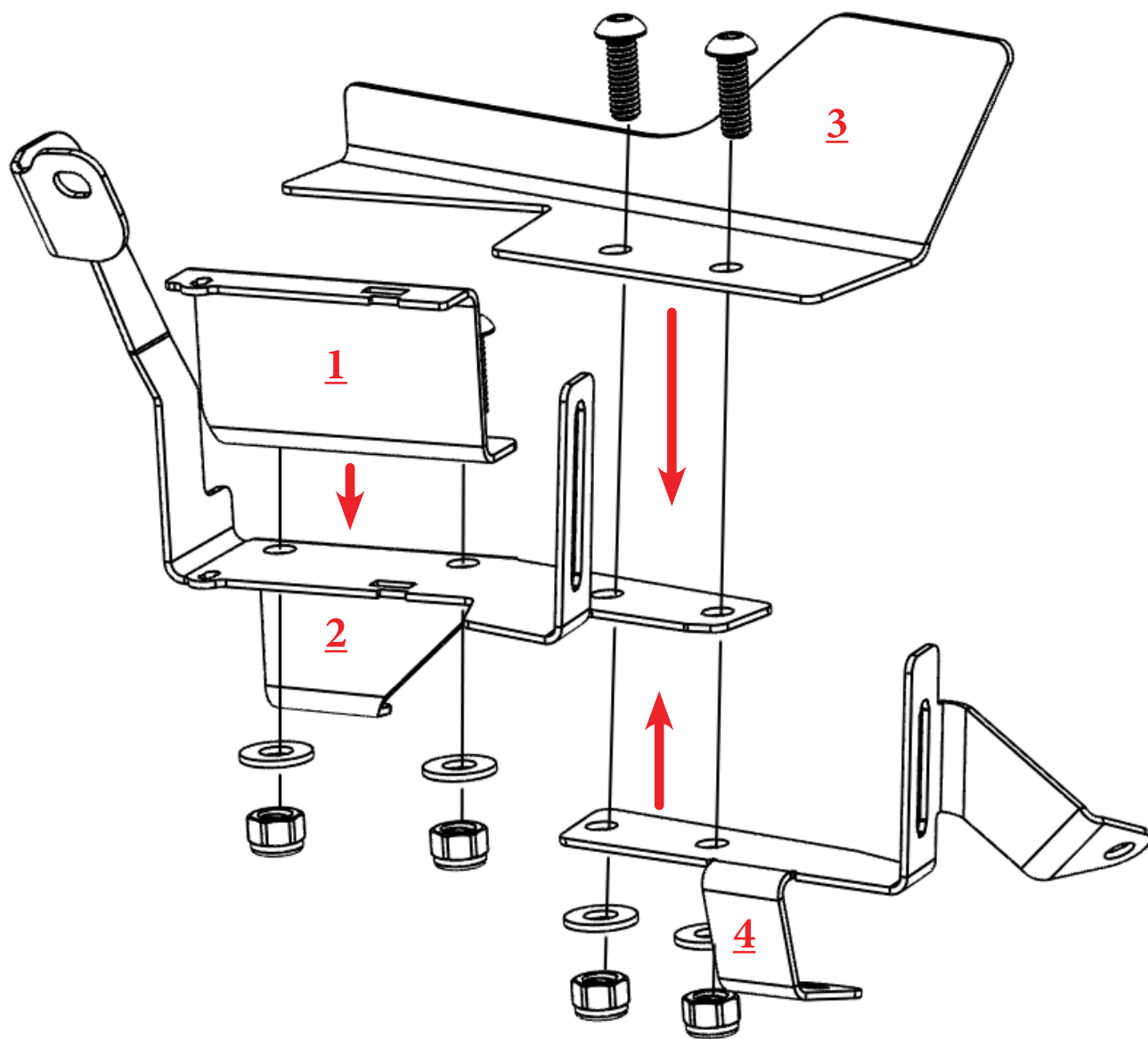

BOMBER REAR BUMPER

2025-UP/RAM RHO

INSTALL

□ STEP 33

With the provided (A, A1, A2) 1/4" hardware install (F, G) brackets with the BSM sensor in between as shown below using a (5/32 allen) and a (7/16 wrench).



A.
A1.
A2.

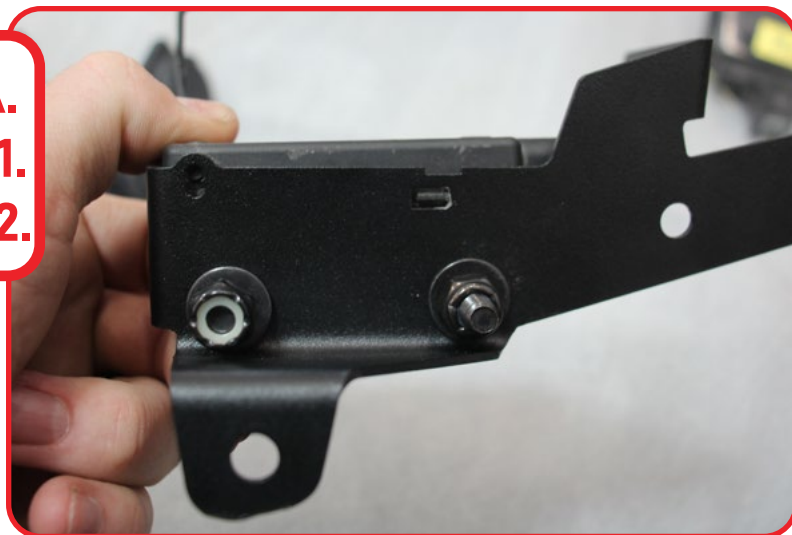



INSTALLATION GUIDE

BOMBER REAR BUMPER

2025-UP/RAM RHO

INSTALL

□ STEP 34

Assemble (E, H) as shown below to (F, G) with the mid range sensor with the provided (A, A1, A2) 1/4" hardware using a (5/32 allen) and a (7/16 wrench).



A.
A1.
A2.



BOMBER REAR BUMPER

2025-UP/RAM RHO

INSTALL

□ STEP 35

Before proceeding, ensure that the bracket assembly looks like the following.



BOMBER REAR BUMPER

2025-UP/RAM RHO

INSTALL

□ STEP 36

Install both driver and passenger brackets assembled on **steps 33-34** inside the bumper behind the plastic covers as shown below with the provided **(A, A1, A2)** 1/4" hardware using a (5/32 allen) and a (7/16 wrench).

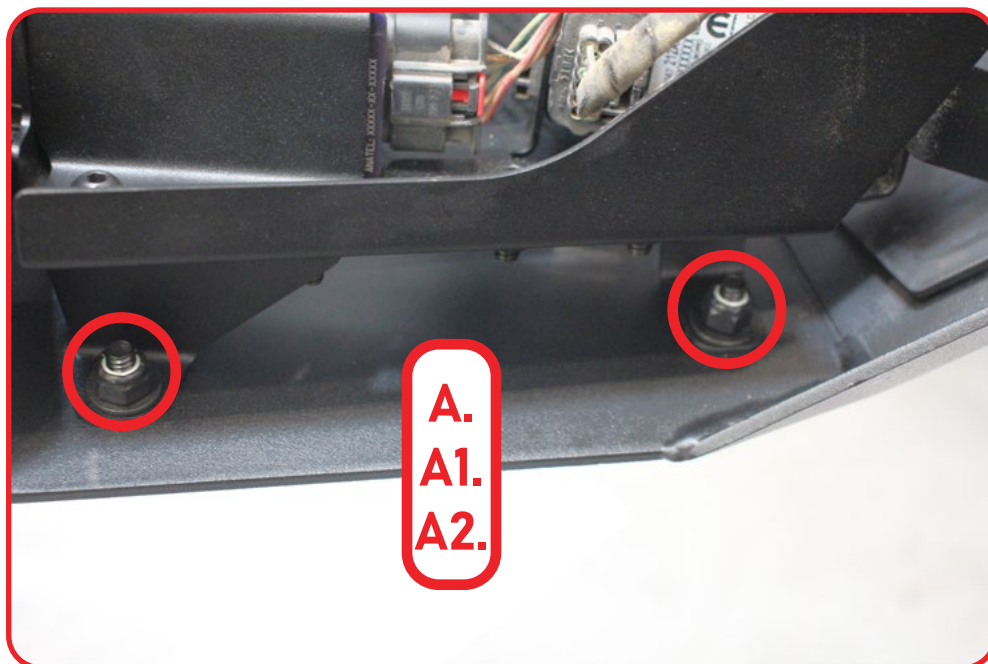



INSTALLATION GUIDE

BOMBER REAR BUMPER

2025-UP/RAM RHO

INSTALL

□ STEP 37

Install the provided (A, A1, A2) 1/4" hardware into the highlighted hole using a (5/32 allen) and a (7/16 wrench).



BOMBER REAR BUMPER

2025-UP/RAM RHO

INSTALL

□ STEP 38

Install the provided (A, A1, A2) 1/4" hardware into the highlighted hole using a (5/32 allen) and a (7/16 wrench).

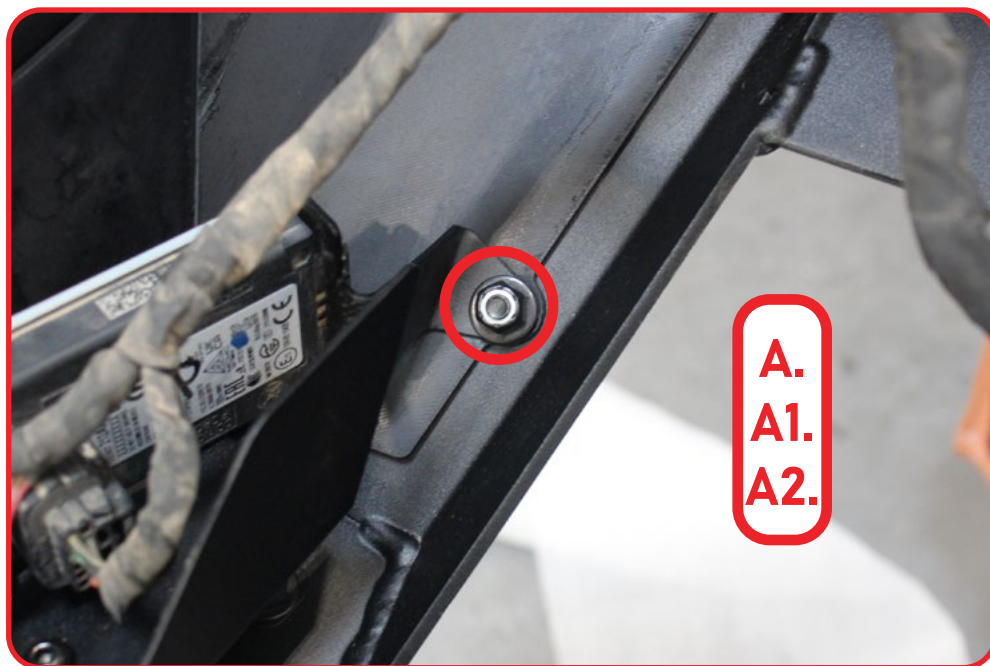



INSTALLATION GUIDE

BOMBER REAR BUMPER

2025-UP/RAM RHO

INSTALL

□ STEP 39

Now would be a good time to install the lights.





INSTALLATION GUIDE

BOMBER REAR BUMPER

2025-UP/RAM RHO

INSTALL

□ STEP 40

Route the wire harness and ensure that all sensors, trailer plugs, and lights are fully installed and plugs are fully seated with no pinched wires.





INSTALLATION GUIDE

BOMBER REAR BUMPER

2025-UP/RAM RHO

INSTALL

□ STEP 41

With a helping hand install the bumper with the provided **(B, B1, B2)** 1/2" hardware using a (3/4 wrench and socket).

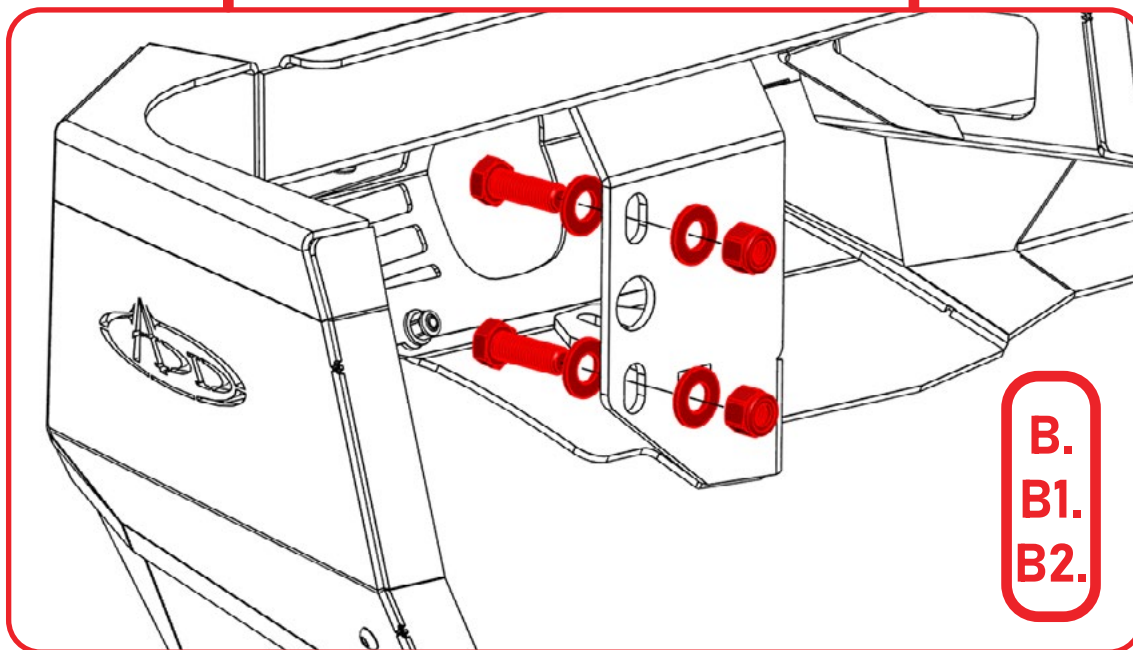



INSTALLATION GUIDE

BOMBER REAR BUMPER

2025-UP/RAM RHO

INSTALL

☐ STEP 42

Plug in the main wire harness located on the driver side.



BOMBER REAR BUMPER

2025-UP/RAM RHO

INSTALL

□ STEP 43

If your RHO is equipped with a side step, remove the plug shown below and install the provided rubber grommet and apply a generous amount of JB weld and re install.



Remove this plug



Install one of the rubber grommets onto it

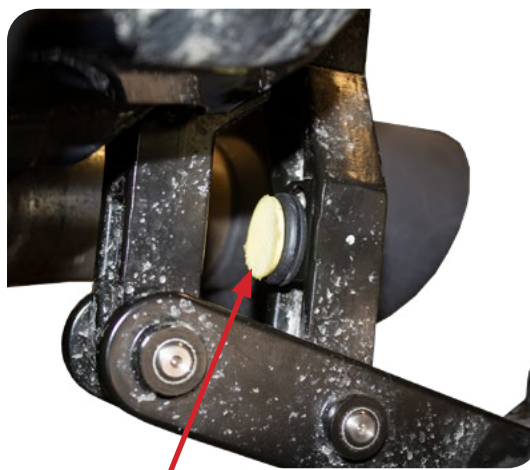

Reinstall the plug



INSTALLATION GUIDE

BOMBER REAR BUMPER

2025-UP/RAM RHO

INSTALL

□ STEP 44

Install the provided (C, C1) license plate hardware as shown below.

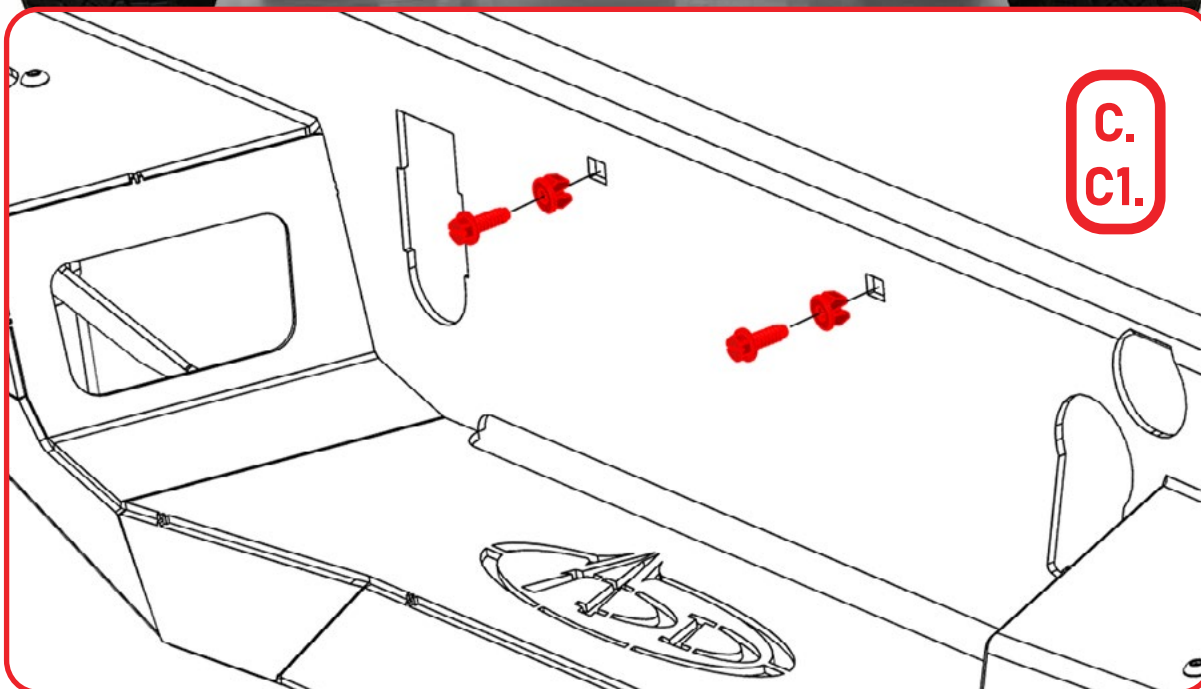



INSTALLATION GUIDE

BOMBER REAR BUMPER 2025-UP/RAM RHO

FINAL

☐ STEP 45

Stand back and enjoy your new ADD Bomber Rear Bumper.

Check and re-tighten all mounting bolts after 100 miles and periodically thereafter.



THIS PRODUCT IS PROTECTED BY ONE OR MORE U.S. PATENTS
WWW.ADDICTIVEDESERTDESIGNS.COM/PATENTS

FOR ADDITIONAL SUPPORT OR TECHNICAL QUESTIONS,
PLEASE CALL 480-671-0820 OR
EMAIL INFO@ADDICTIVEDESERTDESIGNS.COM