



INSTALLATION GUIDE

2024-UP FORD RANGER RAPTOR

EDGE REAR BUMPER

R720295090103



TOOLS REQUIRED

- (Allen) 5/16
- (Wrench) 10mm, 13mm, 15mm, 7/16, 9/16, 3/4
- (Socket) 10mm, 13mm, 15mm, 7/16, 9/16, 3/4
- Ratchet
- Flat Head/Fastener Remover
- Razor Blade



TIME REQUIRED

- 3 hours for OEM Removal/Bumper Install
- 1 Additional Hour to Wire Lights

****Labor Rates are based on a vehicle with no pre-existing damage. Wiring labor is based on a standard wiring procedure with light switches installed in an easily accessible location. Custom light triggering or switch mounting location will result in a greater labor charge.****



SKILL LEVEL

-Easy/Intermediate

****This installation requires 2 people for best results****



INCLUDED IN KIT

- | | |
|-----------------------------------|----------------------------------|
| 4- 1/4-20 x 3/4" button head bolt | 4- 3/8-16" U nuts |
| 4- 1/4-20 Nylon Lock Nut | 2- 1/2-13 x 1 1/2" Hex Head Bolt |
| 4- 1/4 Washer | 2- 1/2-13" Nylon Lock Nut |
| 8- 3/8-16 x 1" Hex Head Bolt | 4- 1/2" Flat Washer |
| 4- 3/8-16" Nylon Lock Nut | 2- Nylon Snap Nuts |
| 4- 3/8" Fender Washer | 2- 1/4 x 3/4 Blunt Screw |
| 8- 3/8" Flat Washer | |

⚠️ WARNINGS/CAUTIONS BEFORE STARTING INSTALLATION ⚠️

-BEFORE YOU INSTALL THIS KIT-

Read and understand all instructions, warnings, cautions, & notes contained in this installation instruction guide. Consult your vehicle owner's manual for proper disconnection of electrical and lifting of vehicle if required for installation of this product.

This install may require some technical skills and knowledge of basic mechanical work. If you do not feel that you are capable of performing this install please take this product to a trained professional.

After reading this guide please contact us with any questions or concerns before installing product.

Customer Service (480) 671-0820

Addictive desert designs is not responsible for any bodily injury or harm to you or your vehicle as a result of an improper install.

Proper installation of this kit required knowledge of the factory recommended procedures for removal and installation of original equipment components.

We recommend that the factory shop manual and any special tools needed to service your vehicle be on hand during the installation. Installation of this kit without proper knowledge of the factory recommended procedures may affect the performance of these

components and the safety of the vehicle. Inspect all contents of this package to make sure product is not damaged and all installation hardware has been included. If parts are missing from kit, please be prepared to provide the following information:

1. Name of purchase location
2. Bar Code on side of box
3. Date above bar code
4. Date inside box cover

ALWAYS WEAR EYE PROTECTION WHEN OPERATING POWER TOOLS



INSTALLATION GUIDE

HARDWARE/PARTS

A.



3/8-16 X 1" HEX HEAD BOLT GRADE 8

QTY: 8

A1.



3/8" FENDER WASHER

QTY: 4

A2.



3/8 FLAT WASHER

QTY: 8

A3.



3/8-16" NYLON LOCK NUT BLACK

QTY: 4

A4.



3/8-16 NUT-U-NUT

QTY: 4

B.



1/4-20 X 3/4" BUTTON HEAD BOLT BLACK

QTY: 4

B1.



1/4 FLAT WASHER BLACK

QTY: 4

B2.



1/4-20" NYLON LOCK NUT BLACK

QTY: 4

C.

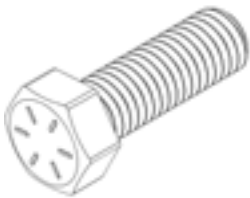

1/2" FLAT WASHER BLACK

QTY: 4

C1.



1/2 FLAT WASHER BLACK

QTY: 2

C2.



1/2-13" NYLON LOCK NUT BLACK

QTY: 2

D.



1/4 X 3/4" TYPE B HEX HEAD BLUNT SCREW

QTY: 2

D1.



NYLON PLASTIC SNAP IN NUT

QTY: 2



INSTALLATION **GUIDE**

EDGE REAR BUMPER 2024-UP RANGER RAPTOR

REMOVAL

STEP 1

Unplug the main wire harness located on the driver side next to the spare tire.





INSTALLATION GUIDE

EDGE REAR BUMPER 2024-UP RANGER RAPTOR

REMOVAL

□ STEP 2

Pull the center plastic highlighted below to expose the mounting hardware.





INSTALLATION GUIDE

EDGE REAR BUMPER 2024-UP RANGER RAPTOR

REMOVAL

□ STEP 3

Using a (13mm socket) remove the mounting hardware.





INSTALLATION GUIDE

EDGE REAR BUMPER 2024-UP RANGER RAPTOR

REMOVAL

□ STEP 4

Using a (13mm socket) remove the mounting hardware as shown below.





INSTALLATION GUIDE

EDGE REAR BUMPER 2024-UP RANGER RAPTOR

REMOVAL

□ STEP 5

Using a (15mm socket) remove the mounting hardware located inside the mounting plate for the hitch highlighted below.

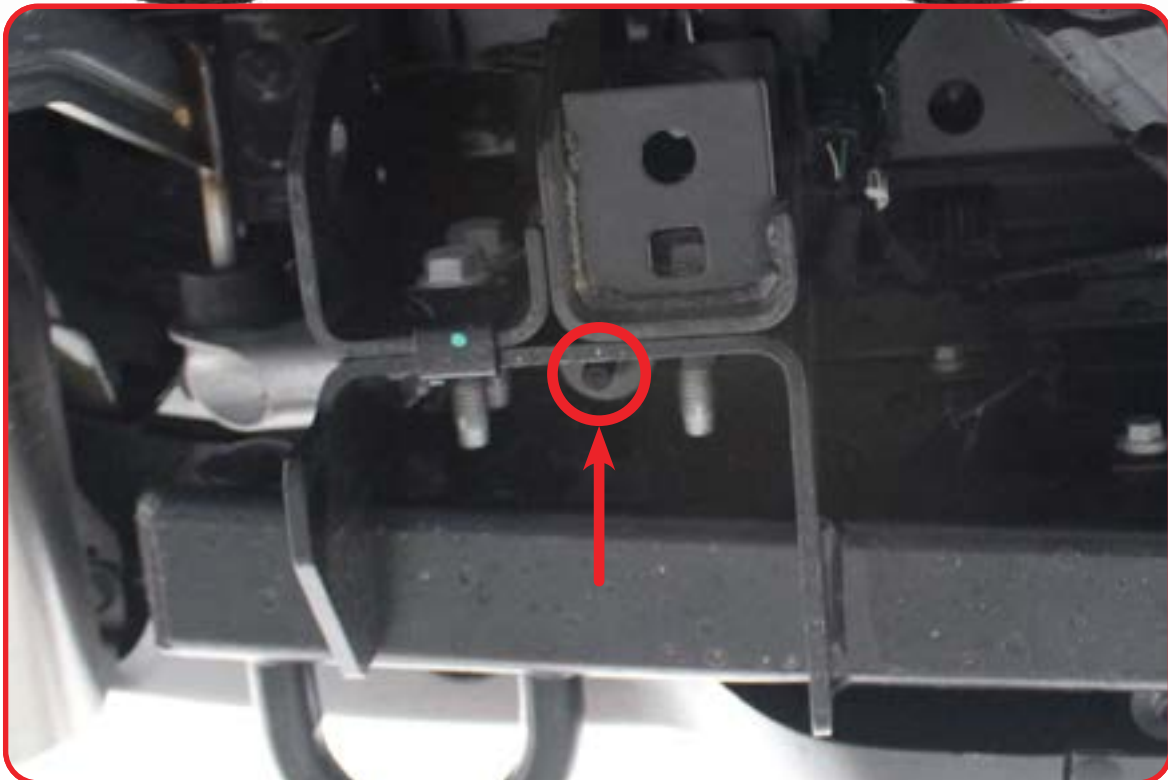



INSTALLATION GUIDE

EDGE REAR BUMPER 2024-UP RANGER RAPTOR

REMOVAL

□ STEP 6

Using a (13mm socket) remove the mounting hardware located inside the center of the bumper on each side of the spare tire.





INSTALLATION **GUIDE**

EDGE REAR BUMPER 2024-UP RANGER RAPTOR

REMOVAL

STEP 7

With a helping hand you can now remove the OEM rear bumper.



EDGE REAR BUMPER 2024-UP RANGER RAPTOR

REMOVAL

□ STEP 8

Using a (flathead screwdriver) remove the license plate light from the backside of the OEM bumper.

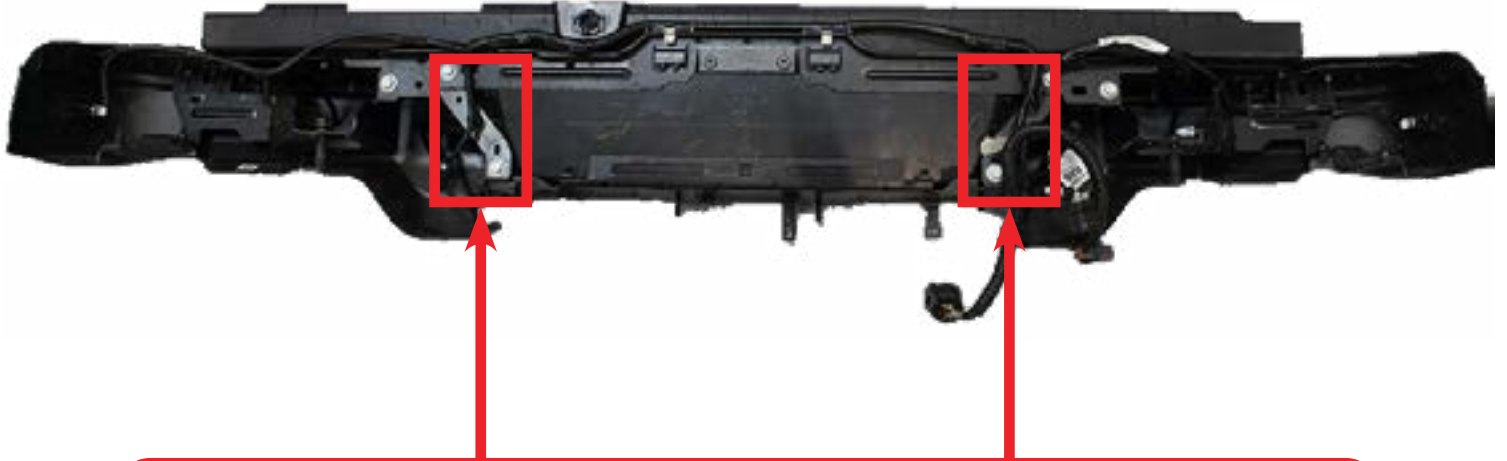

EDGE REAR BUMPER 2024-UP RANGER RAPTOR

REMOVAL

□ STEP 9

Using a (flathead screwdriver) remove the light from the license plate light housing as shown below.
****Keep for install****



EDGE REAR BUMPER 2024-UP RANGER RAPTOR

REMOVAL

□ STEP 10

Using your fingers, remove the 6x sensors from the bezels by prying both tabs on top out and pulling on the sensor. ****Caution!! Be careful for these bezels are fragile****

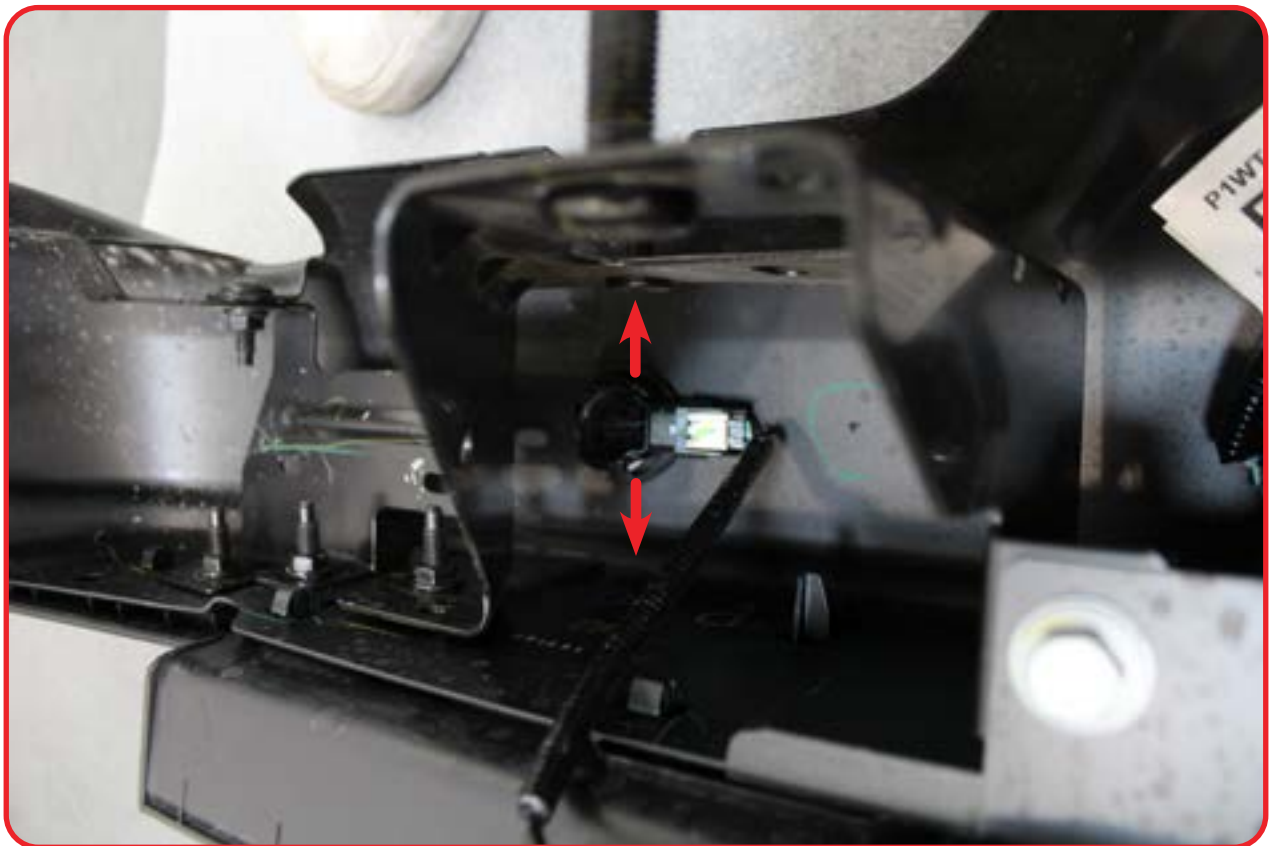

EDGE REAR BUMPER 2024-UP RANGER RAPTOR

REMOVAL

□ STEP 11

For the two outer sensors on each side, Remove the bezels by squeezing the bezel and pulling on the backer as shown below. ****Remember the correct orientation and position****



EDGE REAR BUMPER 2024-UP RANGER RAPTOR

REMOVAL

□ STEP 12

Using a (razor blade) or a (flathead screwdriver) remove middle sensor bezels from the bumper.
****Remember the correct orientation and position****





INSTALLATION GUIDE

EDGE REAR BUMPER 2024-UP RANGER RAPTOR

INSTALL

□ STEP 13

Install the license plate lights removed from **step 9** and install as shown below using the provided brackets and the **(B, B1, B2)** 1/4 hardware using a (5/32 allen) and a (7/16 wrench).

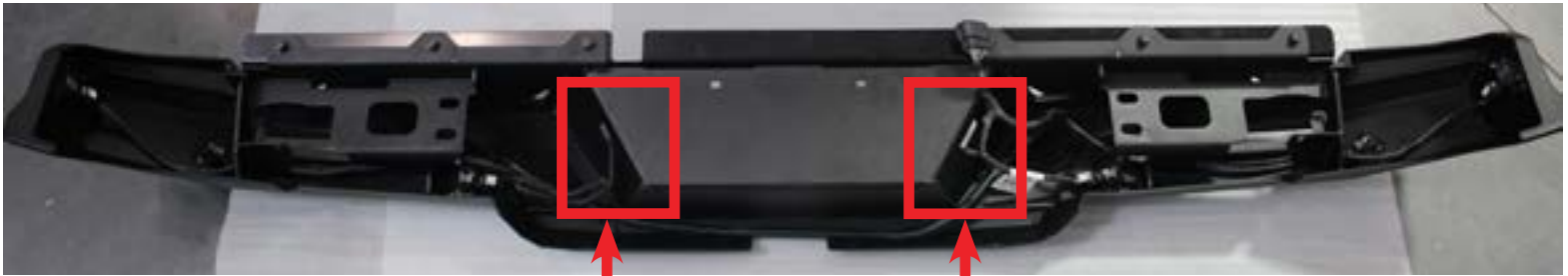

EDGE REAR BUMPER 2024-UP RANGER RAPTOR

INSTALL

□ STEP 14

With the sensor bezels removed from **step 11**, trim the little tabs with a (razor blade) located on the backer as shown below.

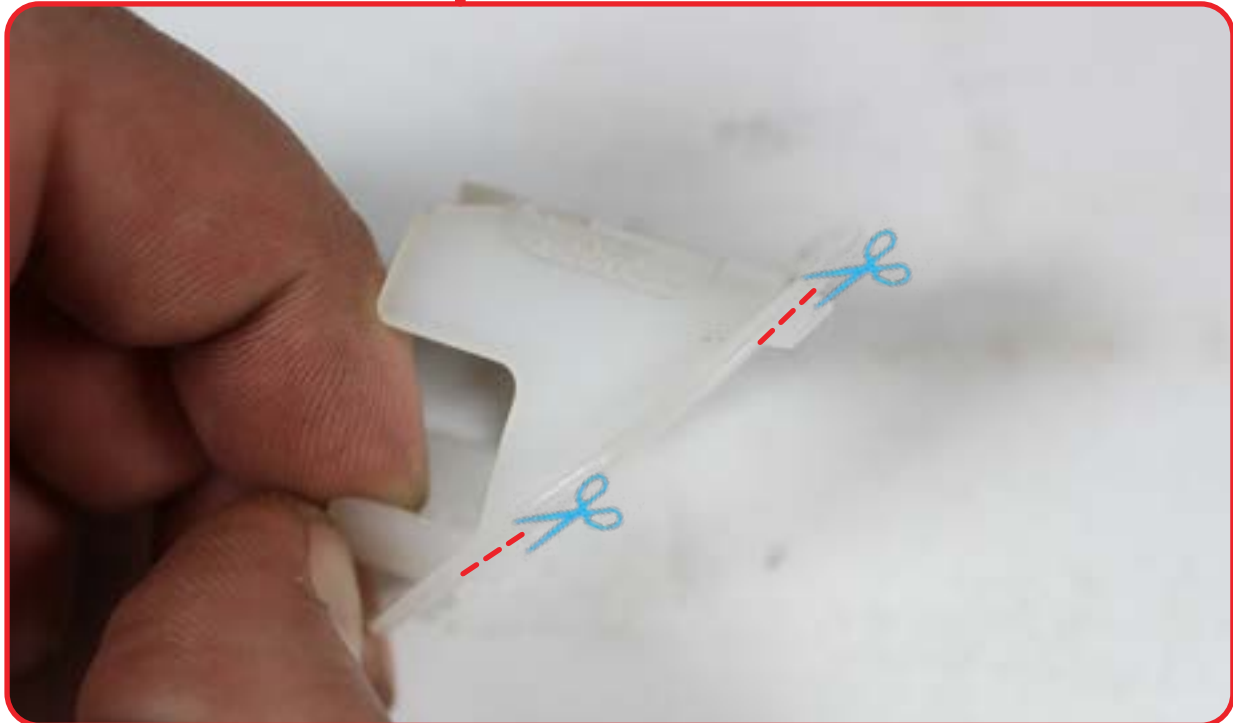

EDGE REAR BUMPER 2024-UP RANGER RAPTOR

INSTALL

□ STEP 15

Install the sensor bezels in the correct orientation from OEM as shown below and insert the sensor.



EDGE REAR BUMPER 2024-UP RANGER RAPTOR

INSTALL

STEP 16

Install the sensor bezels in the correct orientation from OEM as shown below and insert the sensor.





EDGE REAR BUMPER 2024-UP RANGER RAPTOR

INSTALL

STEP 17

Remove double sided tape from the bezel until the surface is clear of residue.





INSTALLATION GUIDE

EDGE REAR BUMPER 2024-UP RANGER RAPTOR

INSTALL

□ STEP 18

Install the provided (F) 3m double sided tape to each side of the bezel wings and trim excess with a (razor blade).

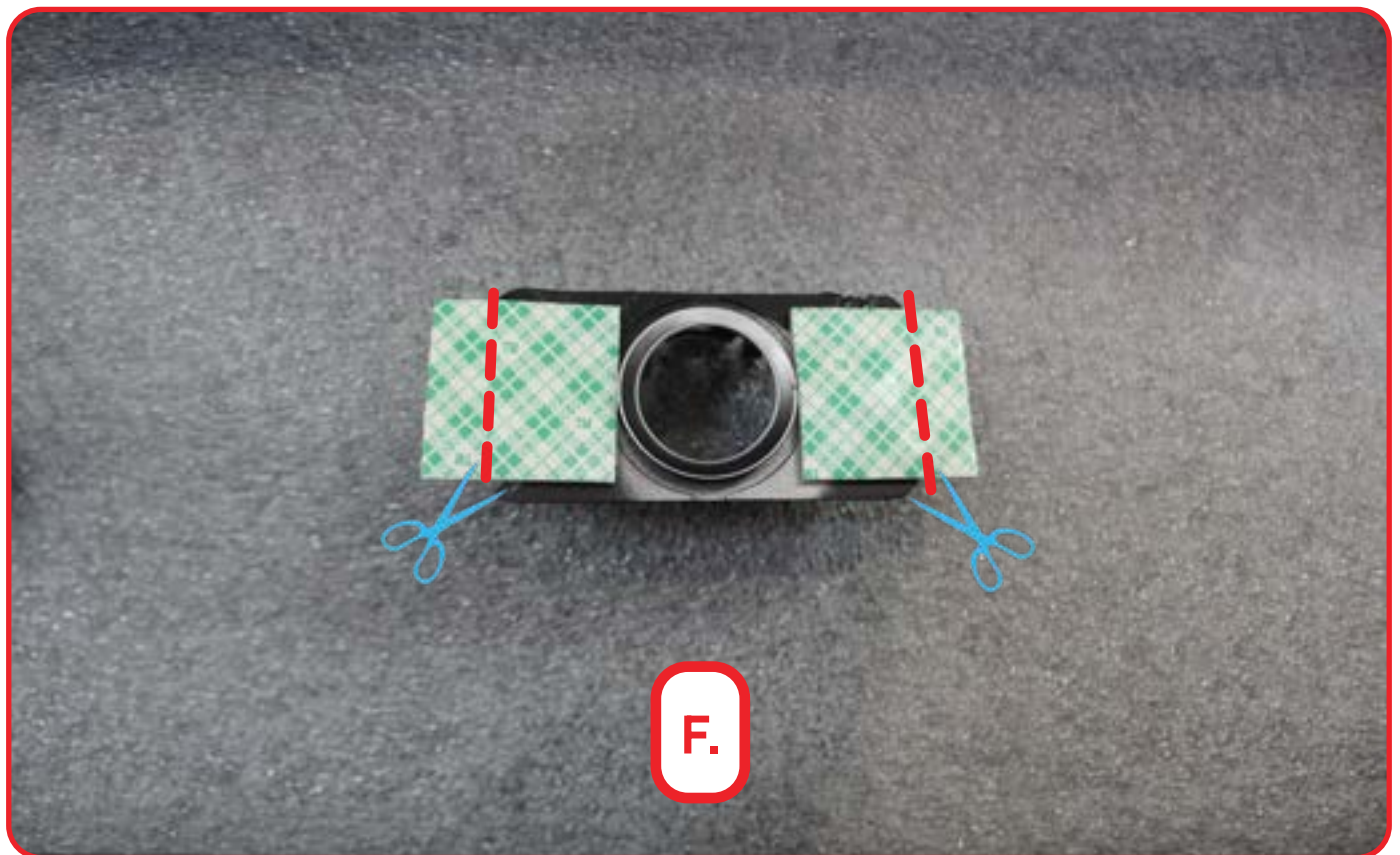



INSTALLATION GUIDE

EDGE REAR BUMPER 2024-UP RANGER RAPTOR

INSTALL

□ STEP 19

Install the center bezels in the correct OEM orientation. ****You will need to trim for the exact fit****





INSTALLATION GUIDE

EDGE REAR BUMPER 2024-UP RANGER RAPTOR

INSTALL

□ STEP 20

Install the (A4) nut clips as shown below.

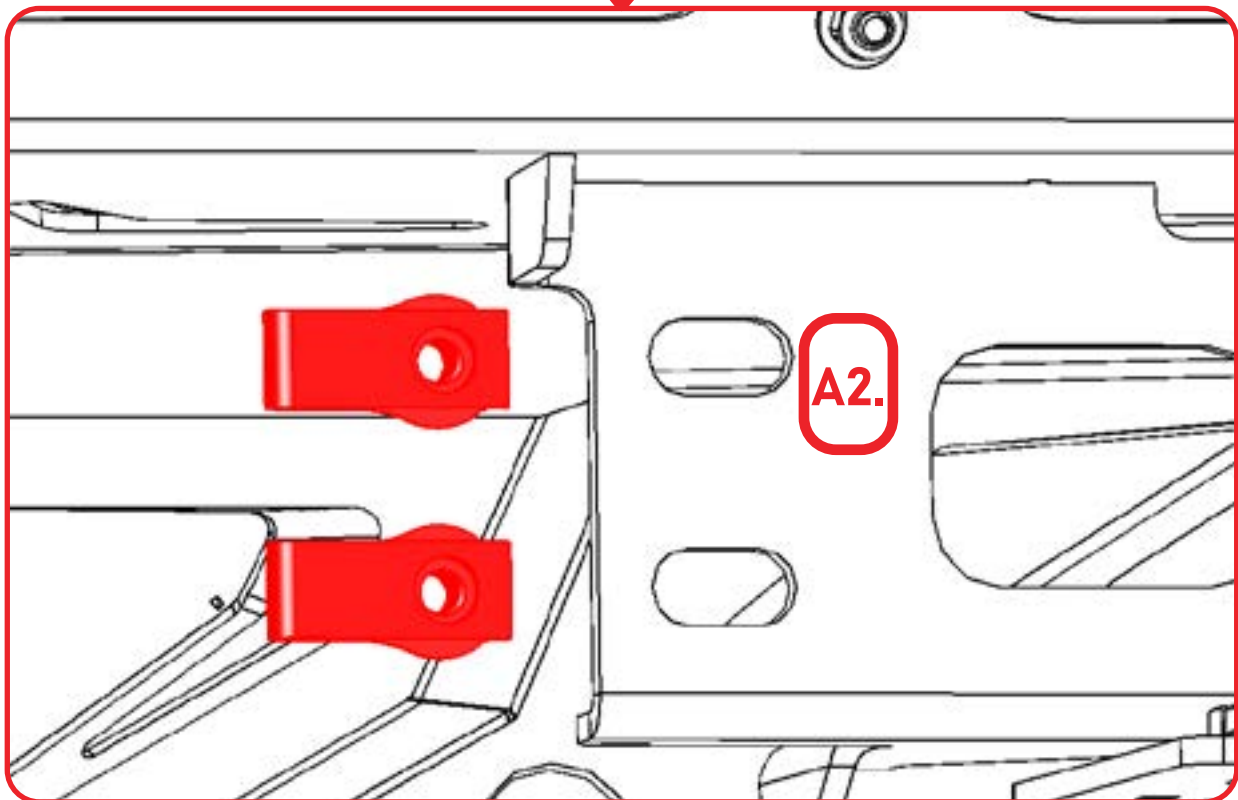

EDGE REAR BUMPER 2024-UP RANGER RAPTOR

INSTALL

□ STEP 21

Using a (10mm socket) remove the exhaust mounts. ****Keep Hardware****





INSTALLATION GUIDE

EDGE REAR BUMPER 2024-UP RANGER RAPTOR

INSTALL

□ STEP 22

Place the mounting plates on top of the hitch bumper mounts ensuring that they are in the correct locations.

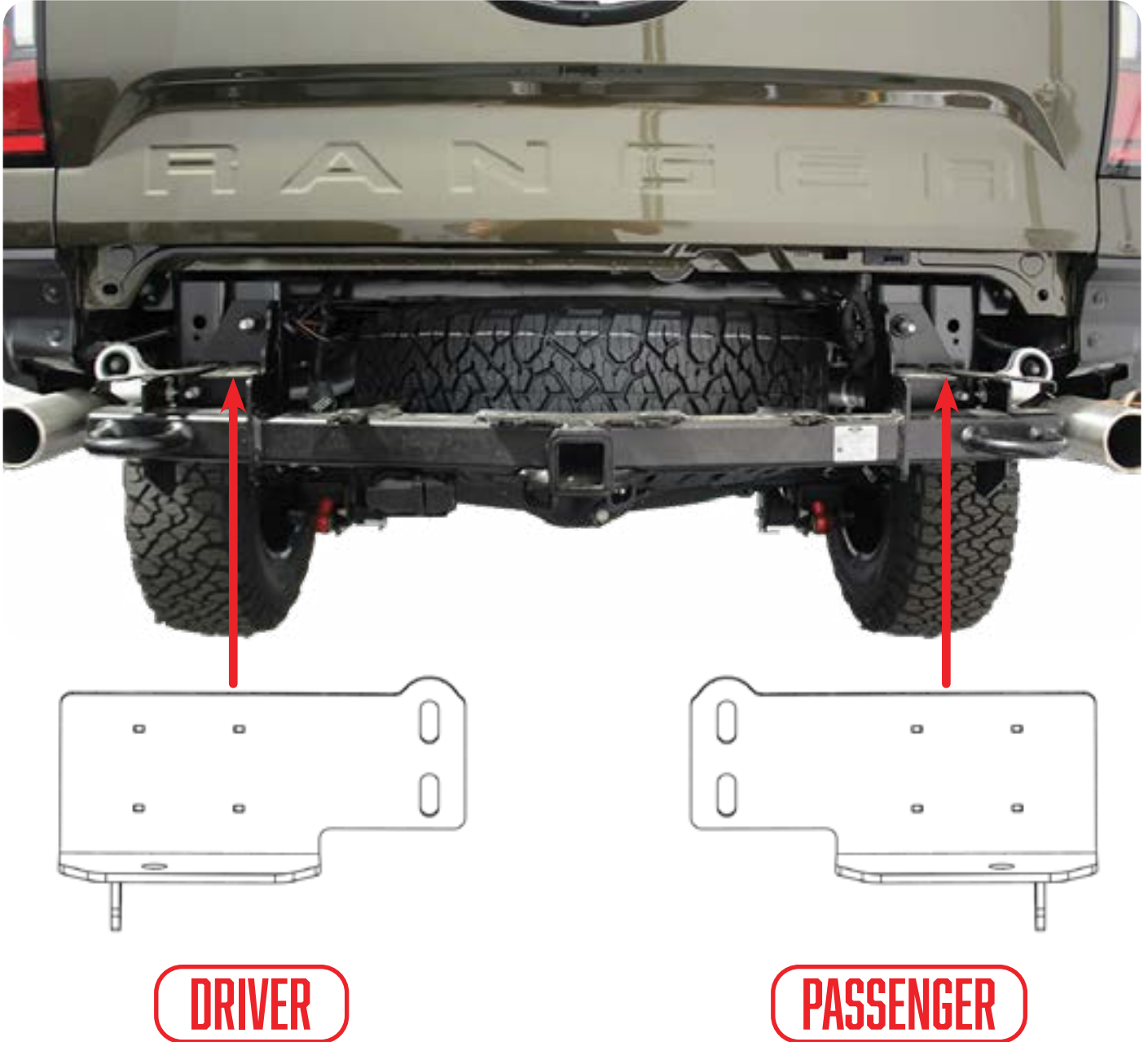



INSTALLATION GUIDE

EDGE REAR BUMPER 2024-UP RANGER RAPTOR

INSTALL

□ STEP 23

Install the (C, C1, C2) 1/2" hardware into the front mounting hole using a (3/4 wrench and socket).

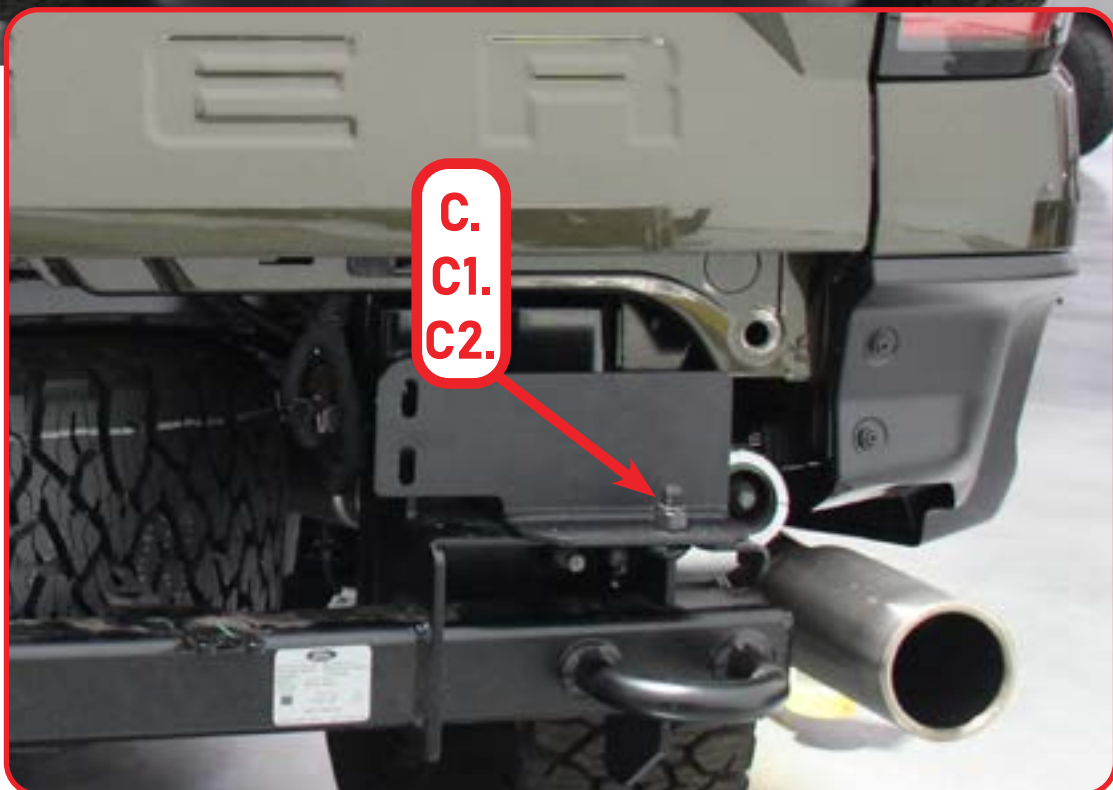



INSTALLATION GUIDE

EDGE REAR BUMPER 2024-UP RANGER RAPTOR

INSTALL

□ STEP 24

With the provided (A, A2, A3) 3/8" hardware, install in the rear holes as shown below using a (9/16 wrench and socket).

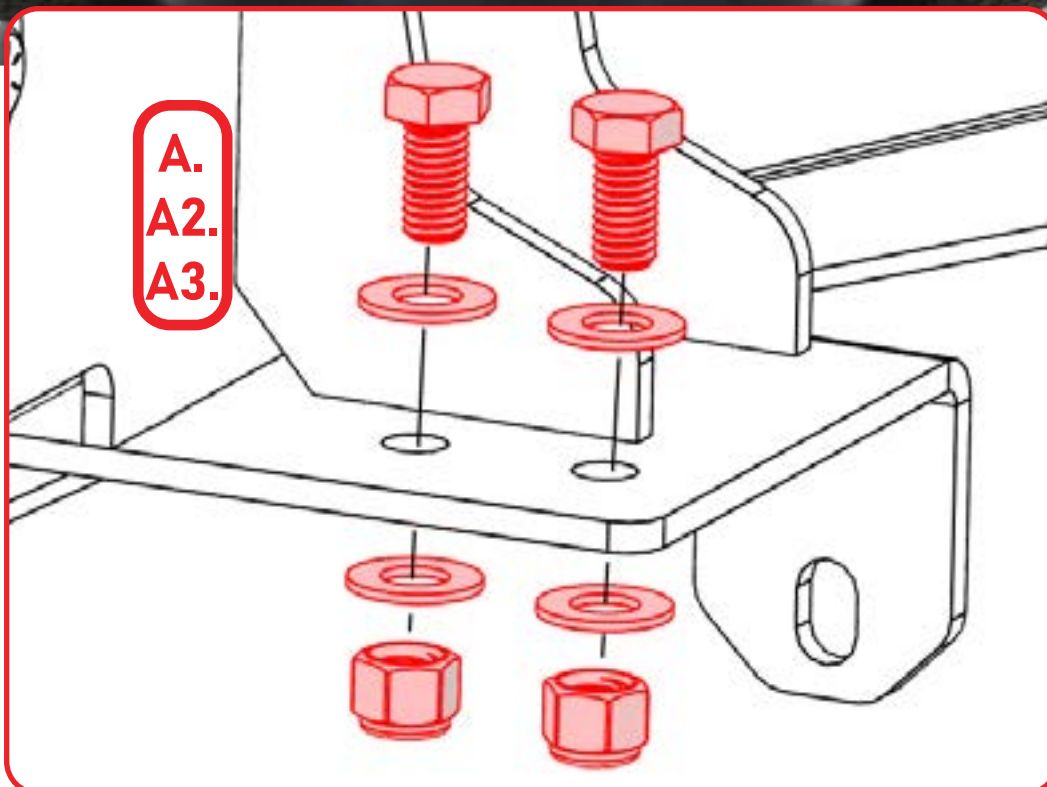

EDGE REAR BUMPER 2024-UP RANGER RAPTOR

INSTALL

STEP 25

Using a (10mm socket) re install the exhaust mount removed from step 20.





INSTALLATION GUIDE

EDGE REAR BUMPER 2024-UP RANGER RAPTOR

INSTALL

□ STEP 26

With a helping hand, you can now install the edge rear bumper with the provided (A, A1) 3/8" hardware using a (9/16 socket).

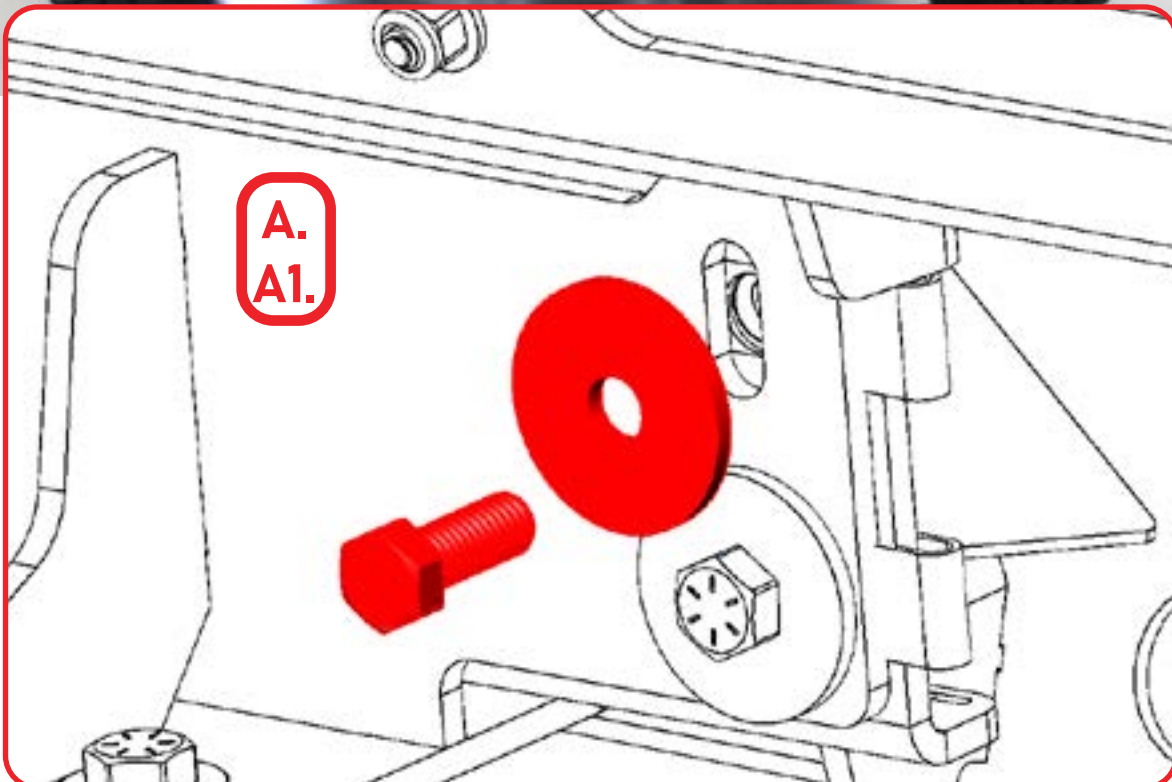
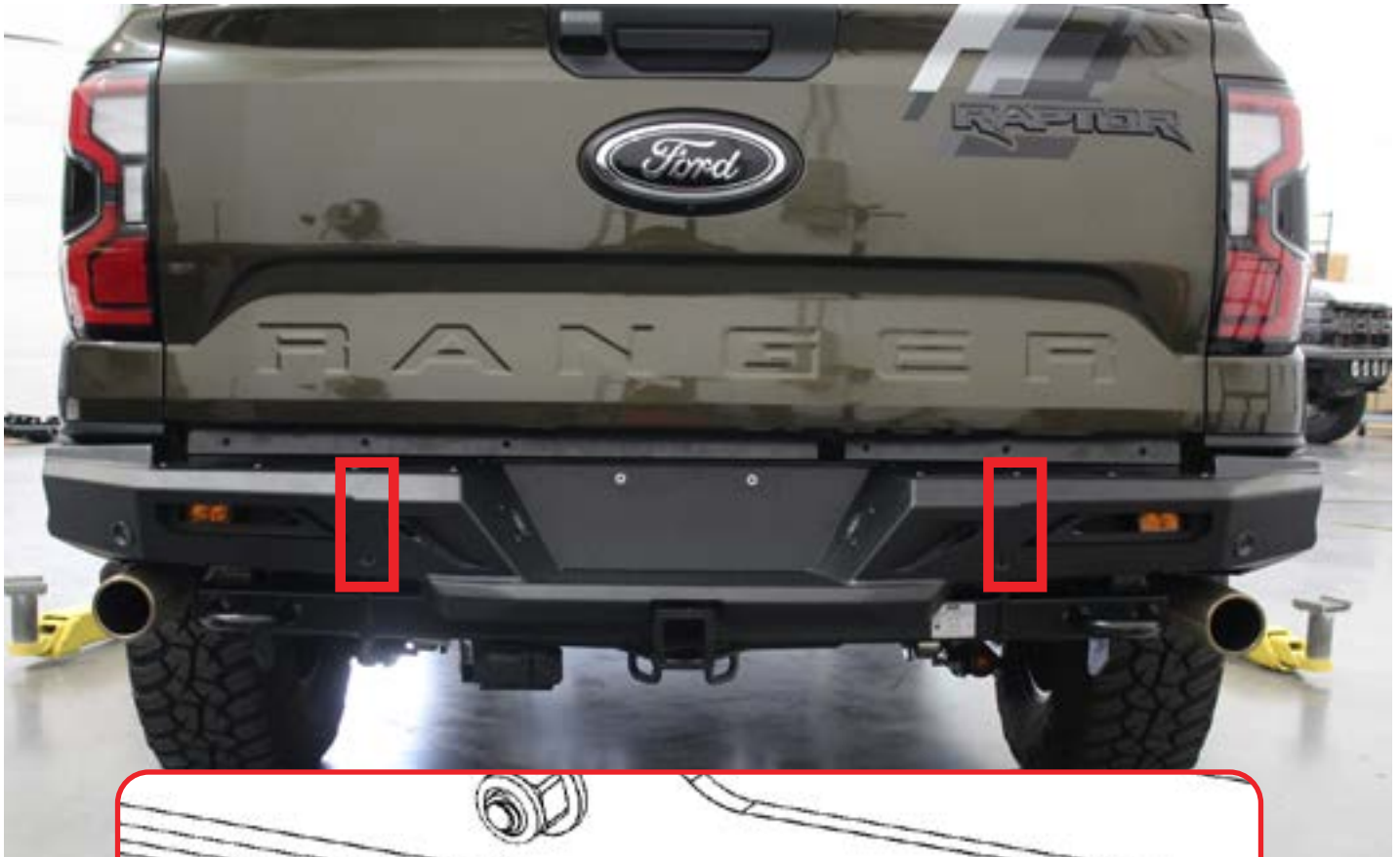



INSTALLATION GUIDE

EDGE REAR BUMPER 2024-UP RANGER RAPTOR

INSTALL

□ STEP 27

Plug the main wire harness back in located on the driver side next to the spare tire.





INSTALLATION GUIDE

EDGE REAR BUMPER 2024-UP RANGER RAPTOR

INSTALL

□ STEP 28

Install the license plate with the provided (D, D1) hardware as shown below using a (flat head).

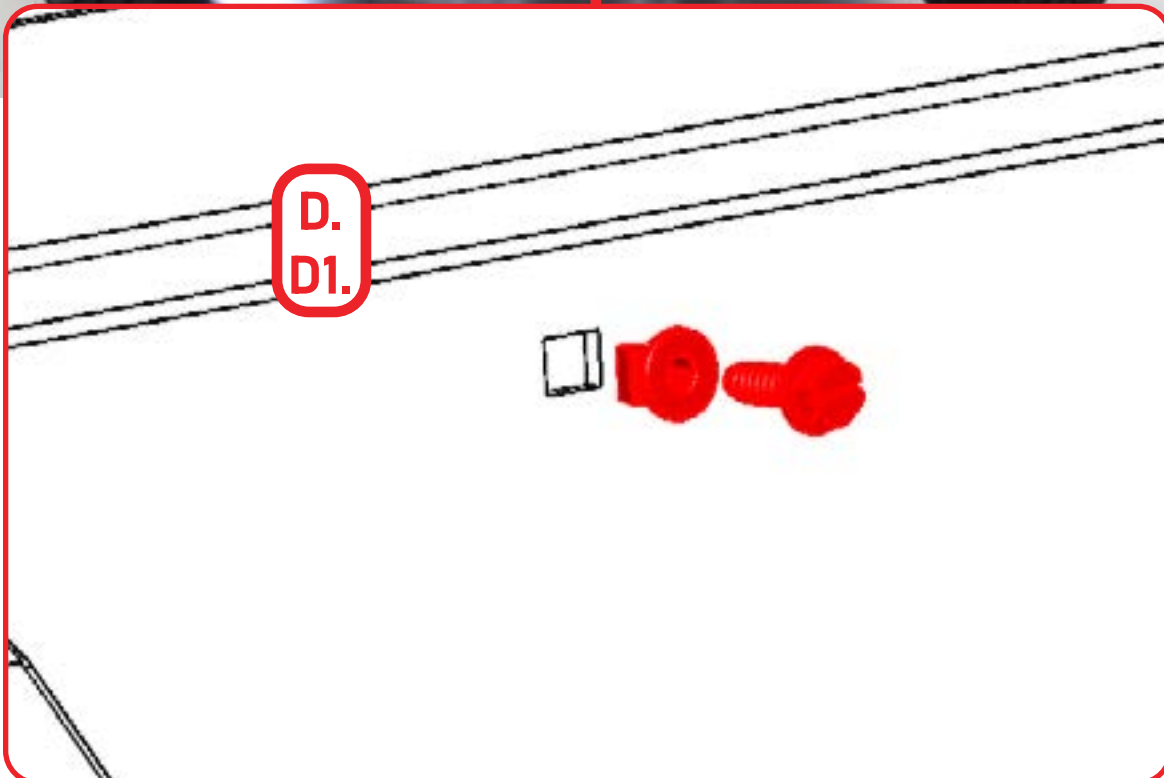



INSTALLATION GUIDE

EDGE REAR BUMPER 2024-UP RANGER RAPTOR

FINAL

STEP 29

Stand back and enjoy your new ADD Edge Rear Bumper.

Check and re-tighten, if needed, all mounting bolts after 100 miles and periodically thereafter.



THIS PRODUCT IS PROTECTED BY ONE OR MORE U.S. PATENTS
WWW.ADDICTIVEDESERTDESIGNS.COM/PATENTS

FOR ADDITIONAL SUPPORT OR TECHNICAL QUESTIONS,
PLEASE CALL 480-671-0820 OR
EMAIL INFO@ADDICTIVEDESERTDESIGNS.COM